



catalogo tecnico • *technical catalogue*

CENTODUCATI

s.p.a.

20051 Limbiate(Mi) Italia – Via 8 Marzo, 27
Tel. ++39/02994771 Fax ++39/0299477001
info@centoducati.com

Spett.le Ditta,

La CENTODUCATI S.p.A. è nata nel 1966 come azienda di carpenteria metallica e ha sviluppato la sua attività intorno a questa sua tipicità.

Non c'è ascensorista in Europa che non abbia almeno una volta installato un'arcata CENTODUCATI, apprezzandone le doti di robustezza e di praticità, data la vastità della gamma di modelli e la flessibilità dell'Ufficio Tecnico, sempre disponibile e pronto ad elaborare soluzioni particolari per casi particolari. Le arcate CENTODUCATI sono a Vostra disposizione per ogni tipo d'impianto, dal piccolissimo ascensore al grande montacarichi idraulico o elettrico.

Nelle pagine seguenti abbiamo raccolto le schede tecniche per le arcate standard e le istruzioni occorrenti per l'uso delle stesse, in modo che la Vostra scelta sia guidata correttamente e quindi l'arcata occorrente possa essere individuata senza incertezze. In ogni caso e nel Vostro interesse è necessario che ogni ordine di arcata venga accompagnato da una copia del disegno d'insieme, per ogni opportuno riscontro.

Per ogni chiarimento rivolgetevi con fiducia al nostro Ufficio Vendite, che saprà consigliarvi per il meglio.

Buon lavoro a tutti!

CENTODUCATI S.p.A.

Dear Sirs,

Centoducati SpA company was founded in 1966 for the metal carpentry working, developing the activity around its own typicality.

There is no lift company in Europe that has not installed at least one sling of CENTODUCATI yet. Particularly appreciated are the characteristics such as sturdiness and practicality for the wide range of models connected to the flexibility of the Technical Office, always willing and open to elaborate special solutions for specific cases.

CENTODUCATI's slings are at your disposal for all kind of lifts, from the smaller ones to the big goods lifts, both hydraulic and electric type.

The attached pages include technical schedules and instructions for the proper use of our standard sling, providing you with correct indications for choosing the suitable sling with no doubts. In any case and in your interest it is necessary that you send each order together with a general layout drawing for the opportune check.

Please do not hesitate to ask for further clarification and our Sales department will suggest you for the best.

Looking forward to hearing from you soon, we send you best regards.

CENTODUCATI S.p.A.

Data	Mod. 1	Mod. 2	Mod. 3	Divieto di riproduzione o di divulgazione (Art. 2-99 Legge 22-4-1947 N. 633)	 Centoducati s.p.a.	Tab.
22/025/03						000.00

INFORMAZIONI GENERALI

GENERAL INFORMATION

DICHIARAZIONE:

Con riferimento all' art. 4 della D.A. 95/16/CE e ai relativi decreti di recepimento da parte dei singoli stati membri, dichiariamo che i componenti da noi prodotti e commercializzati sono destinati ad essere incorporati in un ascensore al quale si applica la predetta Direttiva e sono idonei a tale impiego, nei limiti indicati dalle relative schede tecniche.

CENTODUCATI S.p.A.

DECLARATION:

With reference to the art. 4 of the Lift Directive 95/16/EC and to the corresponding Acknowledgements from the Member States, we declare that the components we produce and place on the market are intended to be incorporated into a lift covered by the above mentioned Directive, within the limits indicated by the related technical sheets.

CENTODUCATI S.p.A.

Data	Mod. 1	Mod. 2	Mod. 3	Divieto di riproduzione o di divulgazione (Art. 2-99 Legge 22-4-1947 N. 633)	 Centoducati s.p.a.	Tab.
28/06/99	03/06/03					001.00

ARCATE ELETTRICHE

La determinazione del tipo di arcata viene effettuata partendo dai dati generalmente disponibili, ossia:

- peso (Pc) e dimensioni della cabina (L x P x H)
- portata dell'ascensore Q
- dimensioni del vano corsa
- scartamento tra le guide Sct
- velocità dell'impianto v

La scelta dell'arcata può essere fatta partendo dal peso della cabina Pc e dalla portata Q o, viceversa, partendo dal peso dell'arcata Pa e dalla portata Q in modo da definire i limiti di peso della cabina Pc, se questa non è ancora definita.

La procedura è la seguente:

1. Identificare un modello di arcata, basandosi su Pc+Q e scartamento Sct.
2. Determinare il peso dell'arcata Pa in relazione allo scartamento Sct mediante le tabelle incluse nelle schede tecniche relative.
3. Calcolare il valore Px e determinare sul diagramma il punto corrispondente allo scartamento. Se la posizione del punto corrisponde all'arcata identificata, il processo è concluso.
4. Se la posizione del punto non corrisponde all'arcata identificata, dovrà essere presa in considerazione l'arcata successiva. Va determinato quindi il peso della nuova arcata Pa, introdotto in Px e verificata la nuova posizione del punto, per controllare che la scelta fatta sia corretta.
5. Se non fosse possibile ottenere dal diagramma una risposta soddisfacente, l'arcata non è standard. In questo caso il nostro Ufficio Vendite provvederà a sviluppare una struttura speciale adeguata alle Vostre necessità.

Le tabelle tecniche che mettiamo a Vostra disposizione riguardano anche due tipi di arcate (35.350 e 35.450) che vengono utilizzate per ascensori ancora a norme EN 81-1 non armonizzate. Questa circostanza va precisata in fase d'ordine in quanto ha conseguenze sulla definizione del prodotto e dei suoi accessori.

CENTODUCATI S.p.A.

ELECTRIC SLINGS SELECTION

The definition of the sling type can be done beginning from the data generally at disposal, that are:

- cabin weight (Pc) and dimensions (L x P x H)
- rated load Q
- shaft dimensions
- distance between guides Sct
- speed v

The choice of the sling can be done beginning from the cabin weight Pc and the lift rated load Q, or vice versa beginning from the sling weight Pa and lift rated load Q so that to define the limits of the cabin weight Pc, in case this is not defined.

The procedure is the following:

1. Identify the sling type on the basis of the lift rated load Q and distance between guides Sct.
2. Define the sling weight Pa in relation to the distance between guides Sct using the tables included in the relevant technical schedules.
3. Calculate the value Px and fix on the diagram the point corresponding to the distance between guides. If the position of the point corresponds to the identified sling, the process is over.
4. If the position of the point does not correspond to the identified sling, it is necessary to consider the next one. Then the weight of the new sling Pa must be determined and added in Px, verifying the new position of the point in order to check if the choice is correct.
5. If it is not possible to obtain a satisfactory answer from the diagram, the sling is not standard. In this case our Sales department will study a special structure according to your need.

The technical tables that we put at your disposal include also two slings, types 35.350 and 35.450, used for lifts still in accordance with EN 81-1 not harmonised. This circumstance must be compulsorily specified in the order because of the effects on the proper definition of the product and related accessories.

CENTODUCATI S.p.A.

Data	Mod. 1	Mod. 2	Mod. 3	Divieto di riproduzione o di divulgazione (Art. 2-99 Legge 22-4-1947 N. 633)	 Centoducati s.p.a.	Tab.
23/025/03						031.10

IMPIANTI ELETTRICI ELECTRIC ELEVATORS

DIAGRAMMA GENERALE DELLE ARCADE SERIE 35-36 GENERAL DIAGRAM OF CAR FRAMES RANGE 35-36

$P_x = P_a + P_c + Q$ kg

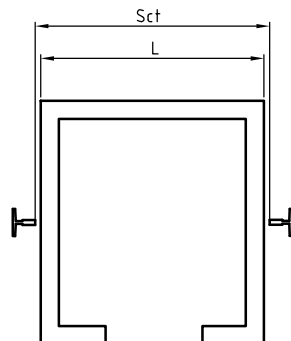
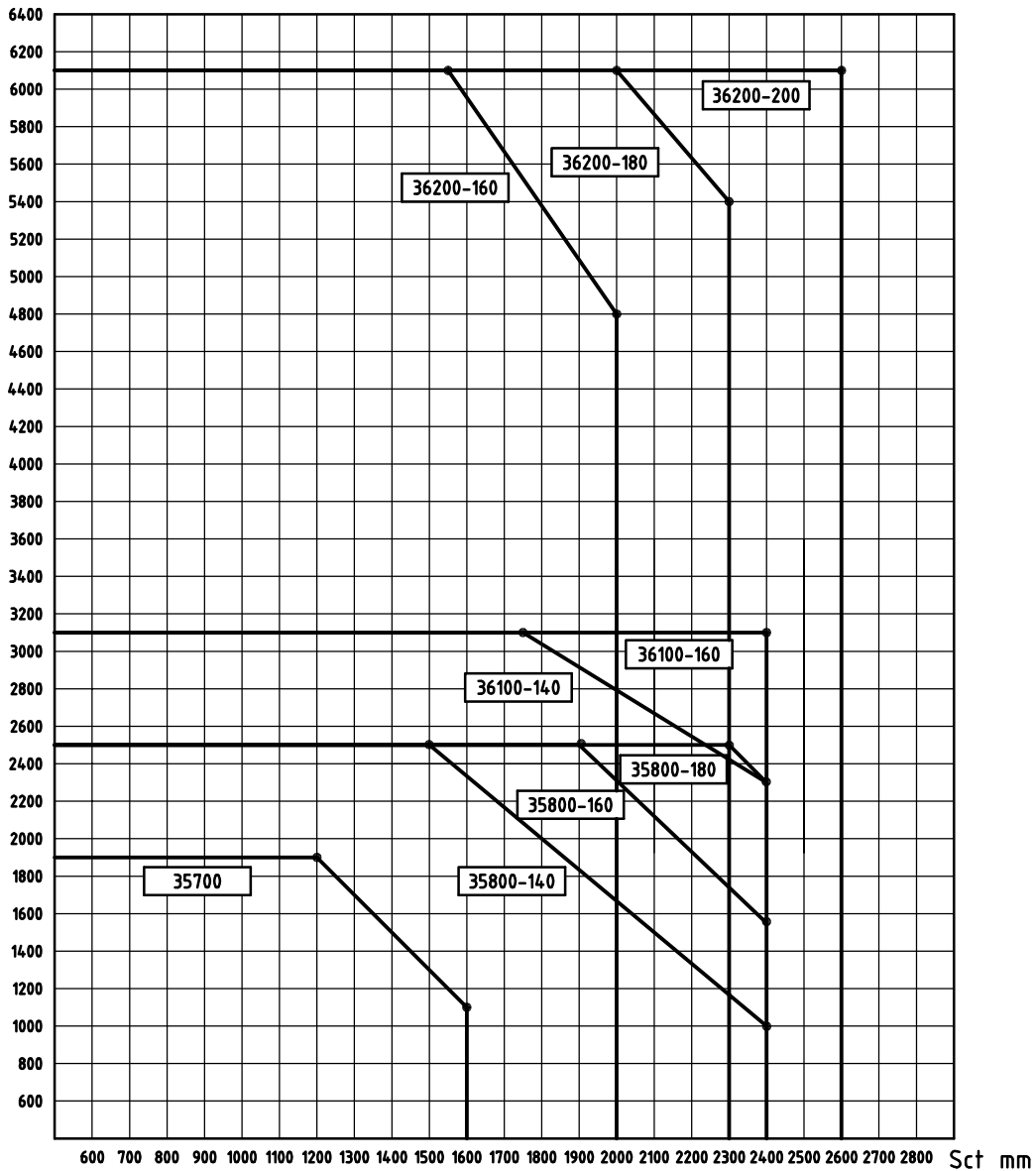

Data	Mod. 1	Mod. 2	Mod. 3	Divieto di riproduzione o di divulgazione (Art. 2-99 Legge 22-4-1947 N. 633)		Tab.
20/02/03	21/05/03					032.00

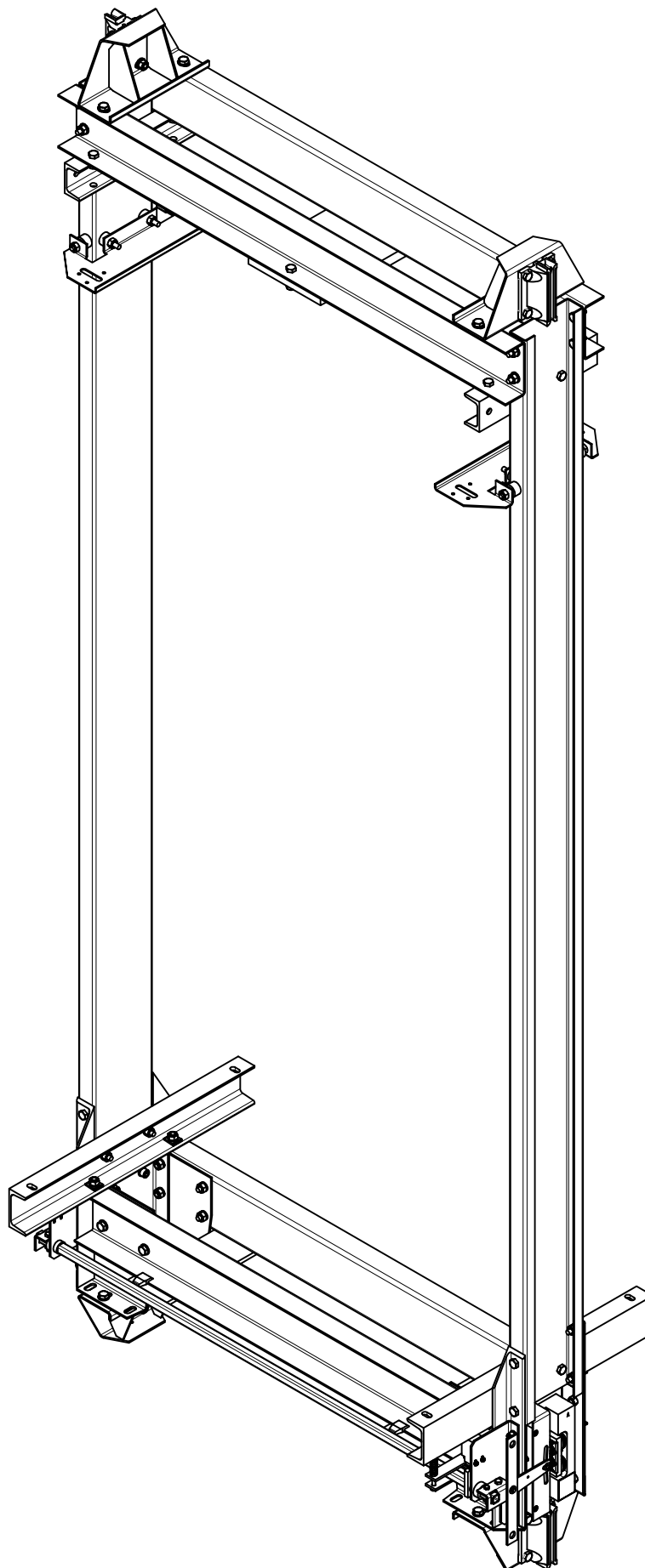

Data	Mod. 1	Mod. 2	Mod. 3	Divieto di riproduzione o di divulgazione (Art. 2-99 Legge 22-4-1947 N. 633)	 Centoducati s.p.a.	Tab.
21/02/03						

IMPIANTI ELETTRICI - ARCATE CABINE ELECTRIC ELEVATORS - CAR FRAMES

TIPO / TYPE 35.600 (1:1)

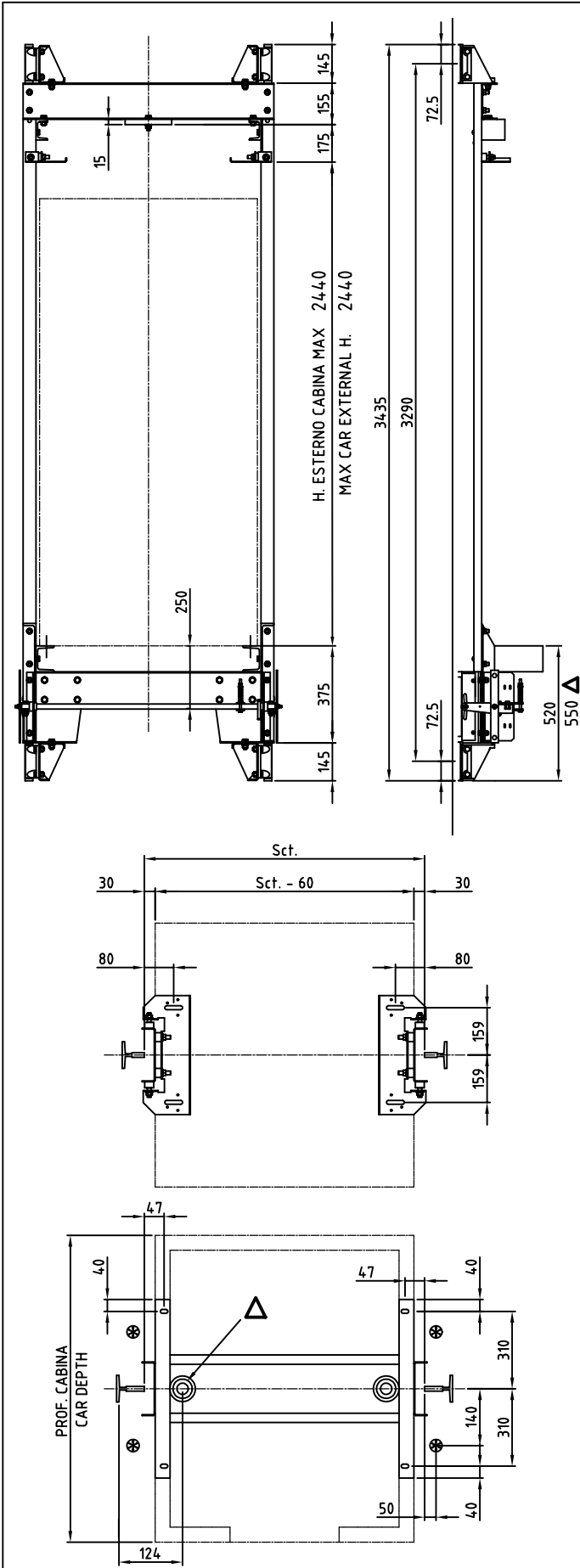

Q = portata rated load
Pc = massa cabina car mass
Pa = massa arcata car frame mass
Px = carico statico max static load max

$$P_x = Q + P_c + P_a \text{ (kg)}$$

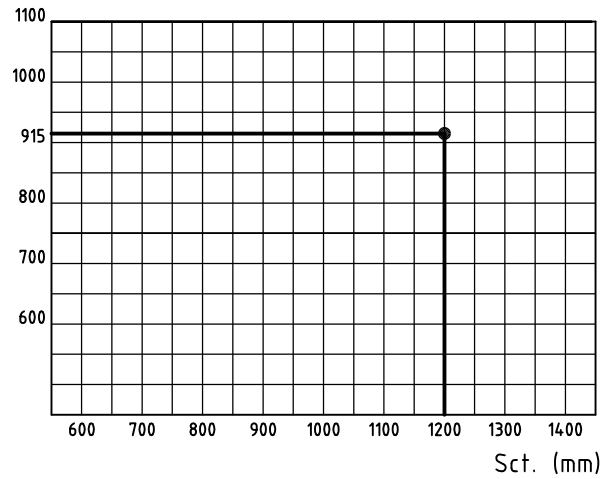

Pa (kg)

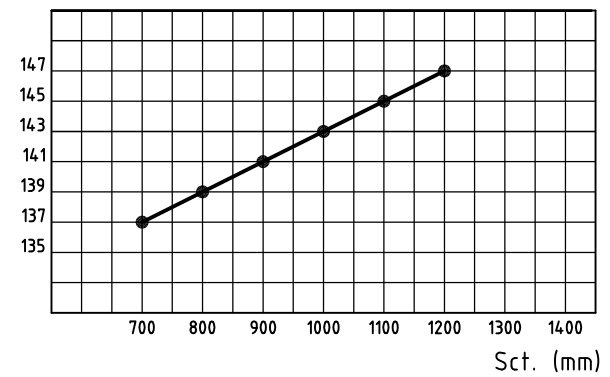

△ Optional: vedi pagina componenti 040.01

△ Optional: see page of components 040.01

⊗ Posizioni possibili attacco funi limitatore

⊗ Possible positions for speed governor rope attachment

Data	Mod. 1	Mod. 2	Mod. 3	Divieto di riproduzione o di divulgazione (Art. 2-99 Legge 22-4-1947 N. 633)	 Centoducati s.p.a.	Tab.
25/02/03						034.00

IMPIANTI ELETTRICI - ARCADE CABINE ELECTRIC ELEVATORS - CAR FRAMES

TIPO / TYPE 35.700 (1:1)

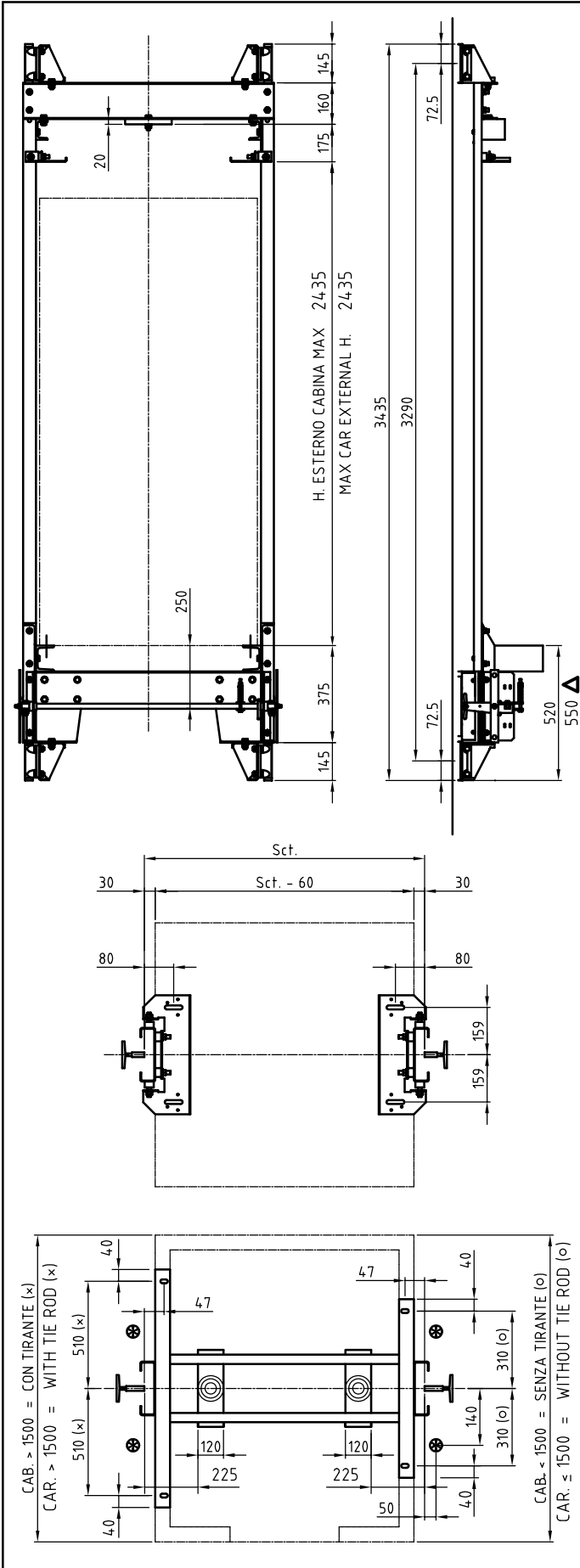

Q = portata rated load
Pc = massa cabina car mass
Pa = massa arcata car frame mass
Px = carico statico max static load max

$$Px = Q + Pc + Pa \text{ (kg)}$$

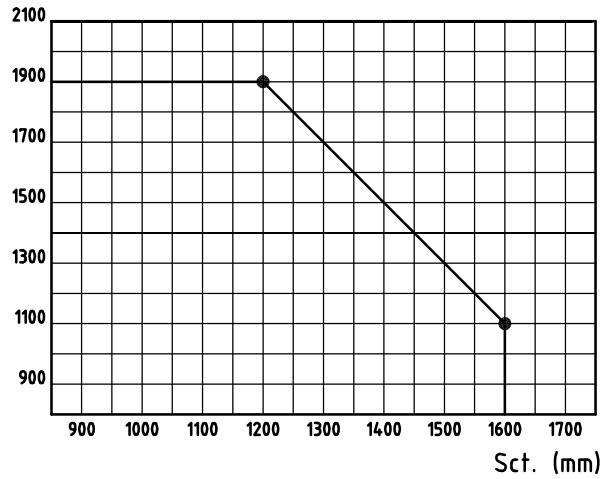

Pa (kg)

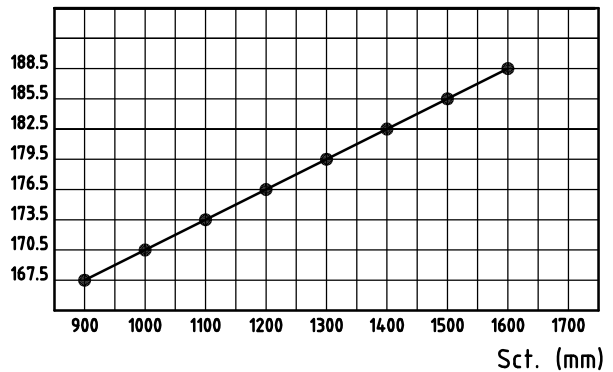

- * Con tiranti Pa + 17,5 Kg.
- * With tie rods Pa + 17,5 Kg.

△ Optional: vedi pagina componenti 040.01

△ Optional: see page of components 040.01

⊗ Posizioni possibili attacco funi limitatore

⊗ Possible positions for speed governor rope attachment

Data	Mod. 1	Mod. 2	Mod. 3	Divieto di riproduzione o di divulgazione (Art. 2-99 Legge 22-4-1947 N. 633)	 Centoducati s.p.a.	Tab.
03/10/2000	27/10/00					035.00

IMPIANTI ELETTRICI - ARcate CABINE ELECTRIC ELEVATORS - CAR FRAMES

TIPO / TYPE 35.800 (1:1)

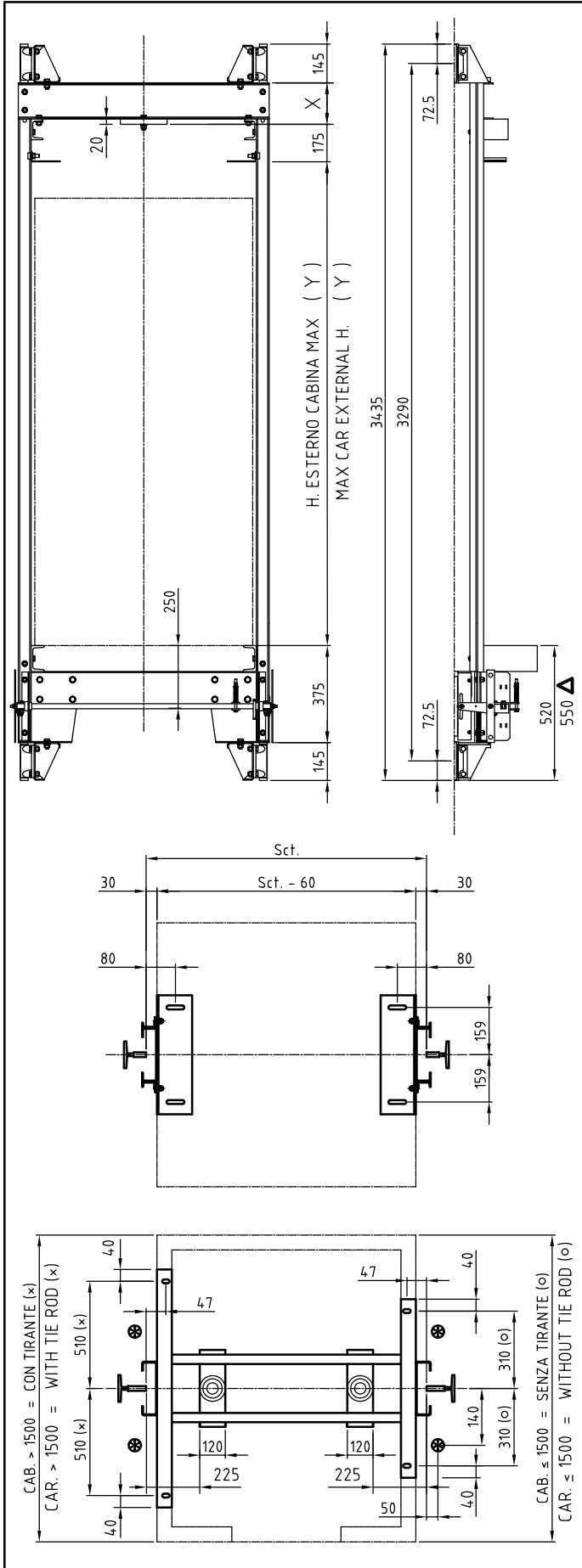

Q = portata
Pc = massa cabina
Pa = massa arcata
Px = carico statico max

rated load
car mass
car frame mass
static load max

$$Px = Q + Pc + Pa \text{ (kg)}$$

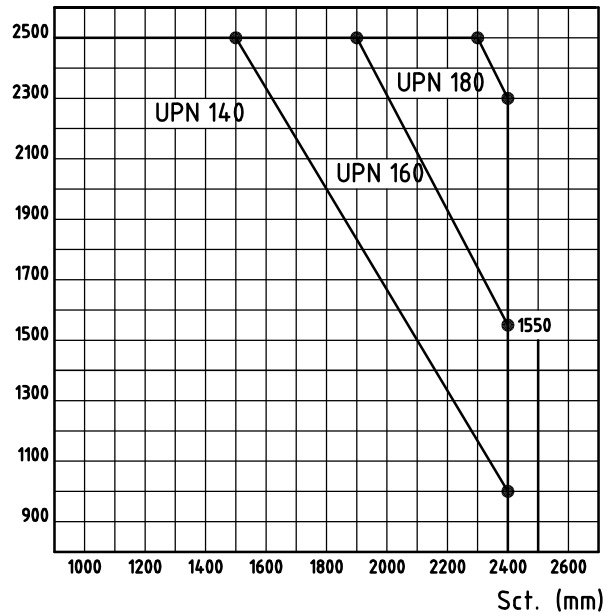

Pa (kg)

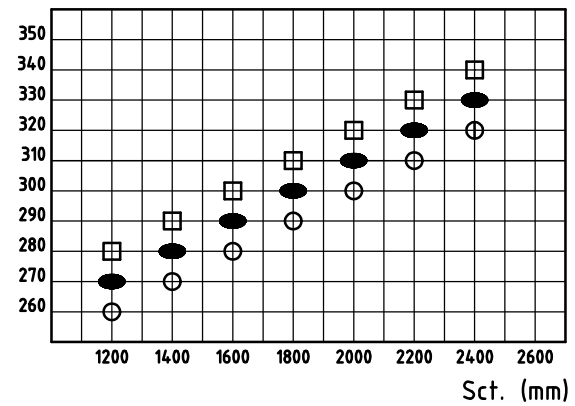

* Con tiranti Pa + 17,5 Kg.
* With tie rods Pa + 17,5 Kg.

UPN mm	X = UPN+20 mm	Y mm
140 ○	160	2435
160 ●	180	2415
180 □	200	2395

△ Optional: vedi pagina componenti 040.01

△ Optional: see page of components 040.01

⊗ Posizioni possibili attacco funi limitatore

⊗ Possible positions for speed governor rope attachment

Data	Mod. 1	Mod. 2	Mod. 3	Divieto di riproduzione o di divulgazione (Art. 2-99 Legge 22-4-1947 N. 633)	 Centoducati s.p.a.	Tab.
03/10/2000	27/10/00					038.00

COMPONENTI ARCADE CAR FRAME COMPONENTS

35.600 / 35.700 / 35.800 FRAMES

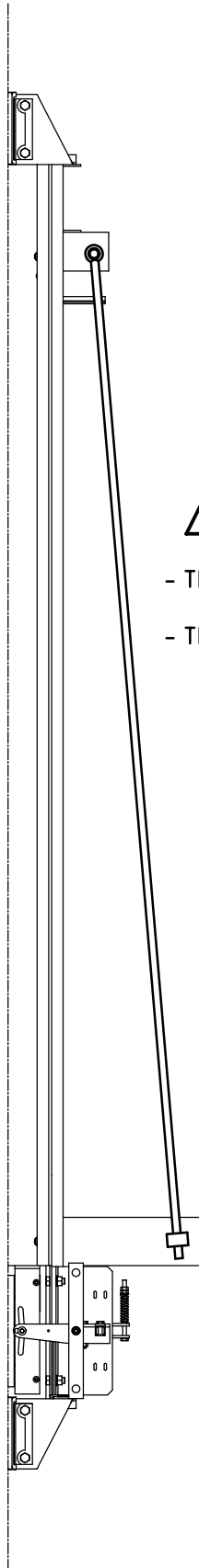

△ - OPTIONAL
- TIRANTE
- TIE ROD

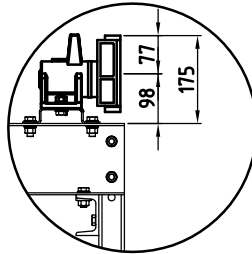

△ - OPTIONAL

- PATTINO IN LEGA DI METALLO SUP.
- UPPER ALLOY GUIDE SHOES

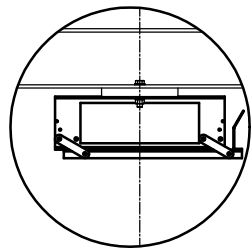

△ - OPTIONAL

- DISPOSITIVO ALLENTAMENTO FUNI
- SLACK ROPE DEVICE

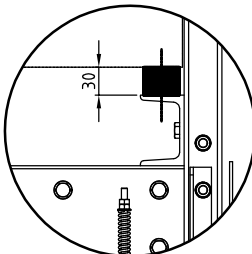

△ - OPTIONAL

- TAMPONI IN GOMMA
- RUBBER PADS

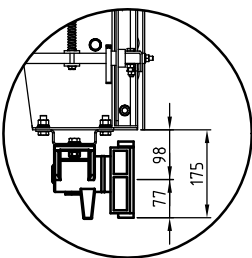

△ - OPTIONAL

- PATTINO IN LEGA DI METALLO INF.
- LOWER ALLOY GUIDE SHOES

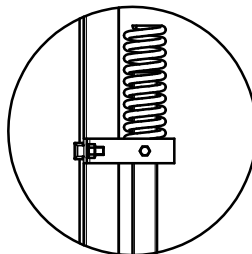

△ - OPTIONAL

- AMMORTIZZATORE FONDO FOSSA
- SPRING BUFFER

Data	Mod. 1	Mod. 2	Mod. 3	Divieto di riproduzione o di divulgazione (Art. 2-99 Legge 22-4-1947 N. 633)	 Centoducati s.p.a.	Tab.
02/08/00	26/02/03					040.01

IMPIANTI ELETTRICI ARCADE CABINA

ELECTRIC ELEVATORS CAR SLINGS

TIPO/TYPE 36.100 (1:1)

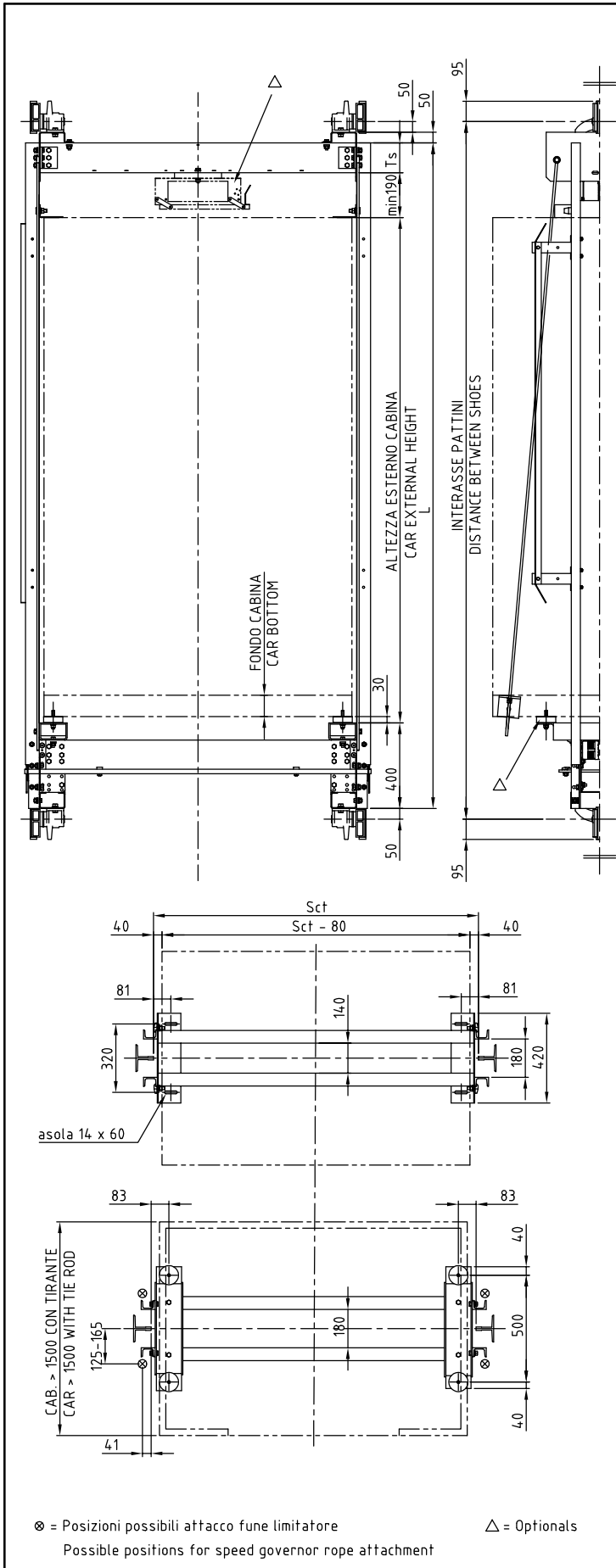

- Q = portata rated load
 Pc = massa cabina car mass
 Pa = massa arcata car frame mass
 Px = carico statico max static load max

TIPO/TYPE	36100-140	36100-160
Ts	UPN 140	UPN 160

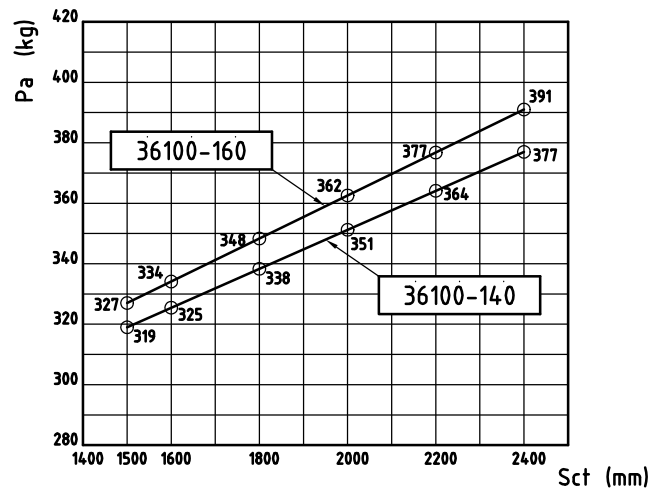
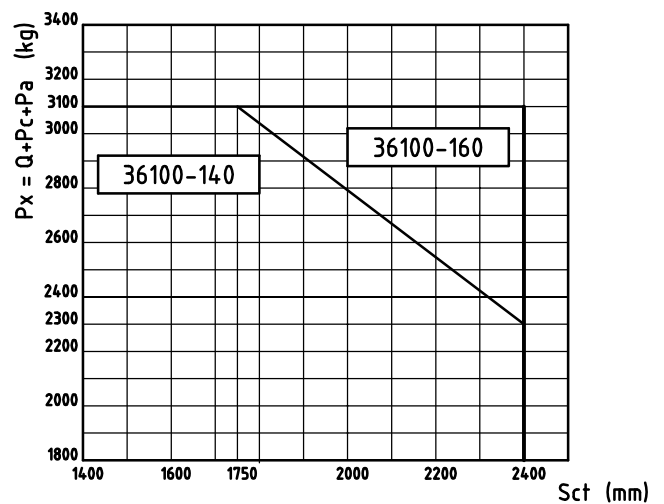

Valori di Pa con montanti standard (L = 3000)
 Pa values with standard side sleepers (L = 3000)

MAGGIORAZIONE MASSE ADDITIONAL MASSES	kg
Esecuzione con tiranti Execution with tie rods	17.5
Altezza montanti superiore allo standard (ogni 100 mm) Side sleepers higher than standard (each 100 mm)	2,84

Data	Mod. 1	Mod. 2	Mod. 3	Divieto di riproduzione o di divulgazione (Art. 2-99 Legge 22-4-1947 N. 633)	 Centoducati s.p.a.	Tab.
11/07/02	01/08/02					041.00

IMPIANTI ELETTRICI ARCADE CABINA ELECTRIC ELEVATORS CAR SLINGS

TIPO/TYPE 36.100 (1:1)

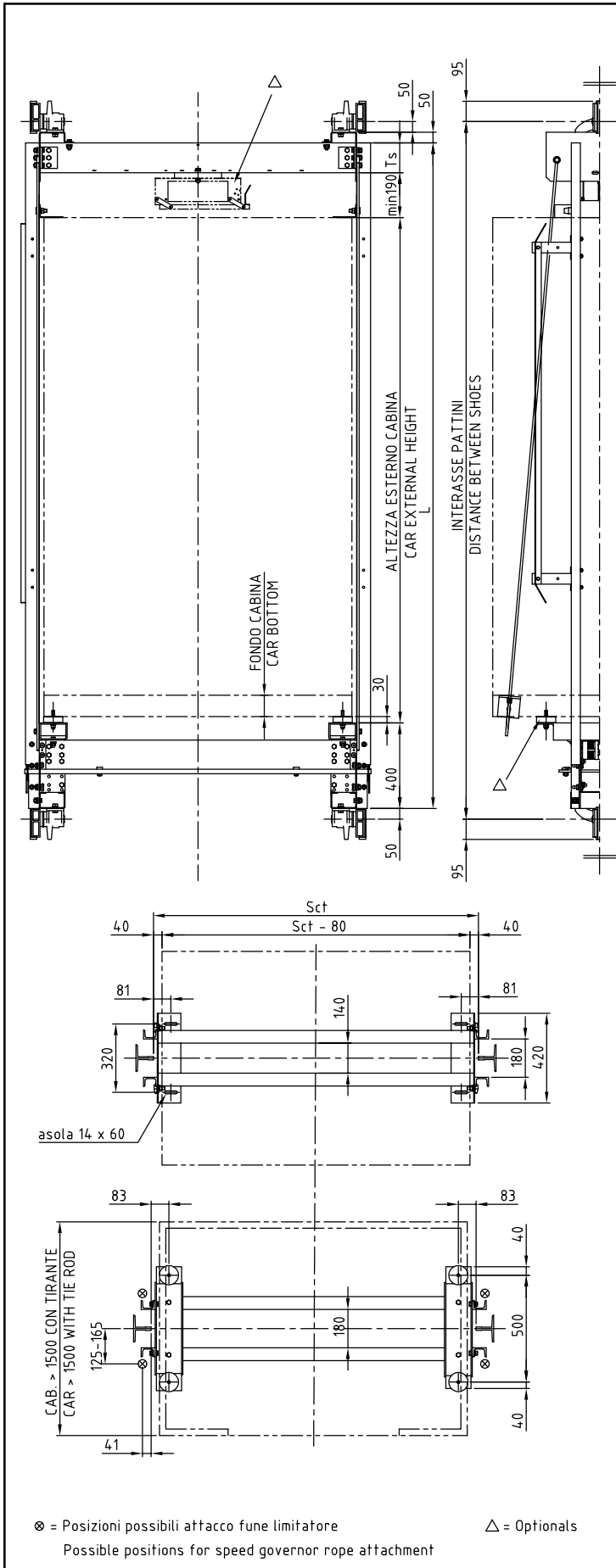

- Q = portata rated load
 Pc = massa cabina car mass
 Pa = massa arcata car frame mass
 Px = carico statico max static load max

TIPO/TYPE	36100-140	36100-160
Ts	UPN 140	UPN 160

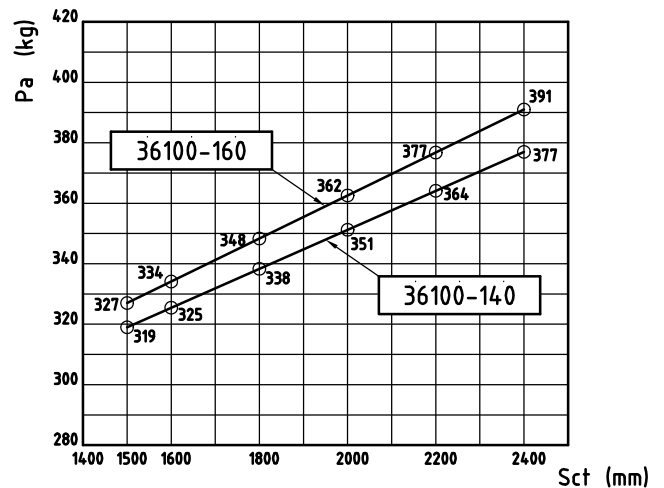
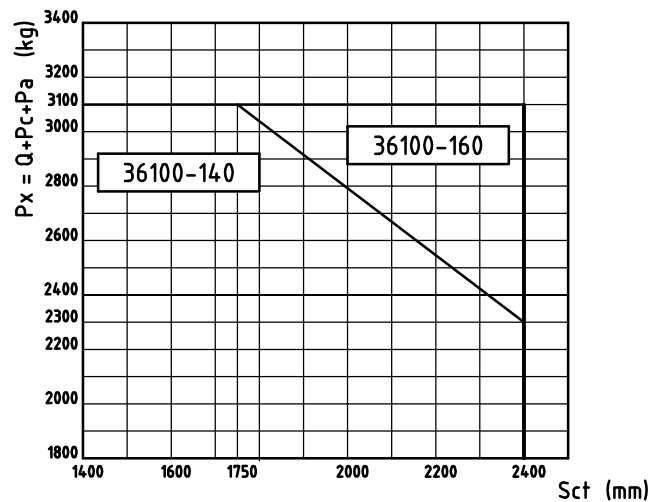

Valori di Pa con montanti standard (L = 3000)
 Pa values with standard side sleepers (L = 3000)

MAGGIORAZIONE MASSE ADDITIONAL MASSES	kg
Esecuzione con tiranti Execution with tie rods	17.5
Altezza montanti superiore allo standard (ogni 100 mm) Side sleepers higher than standard (each 100 mm)	2,84

Data	Mod. 1	Mod. 2	Mod. 3	Divieto di riproduzione o di divulgazione (Art. 2-99 Legge 22-4-1947 N. 633)	 Centoducati s.p.a.	Tab.
11/07/02	01/08/02					041.00

IMPIANTI ELETTRICI ARCADE CABINA ELECTRIC ELEVATORS CAR SLINGS

TIPO/TYPE 36.100 (2:1 SUP.)

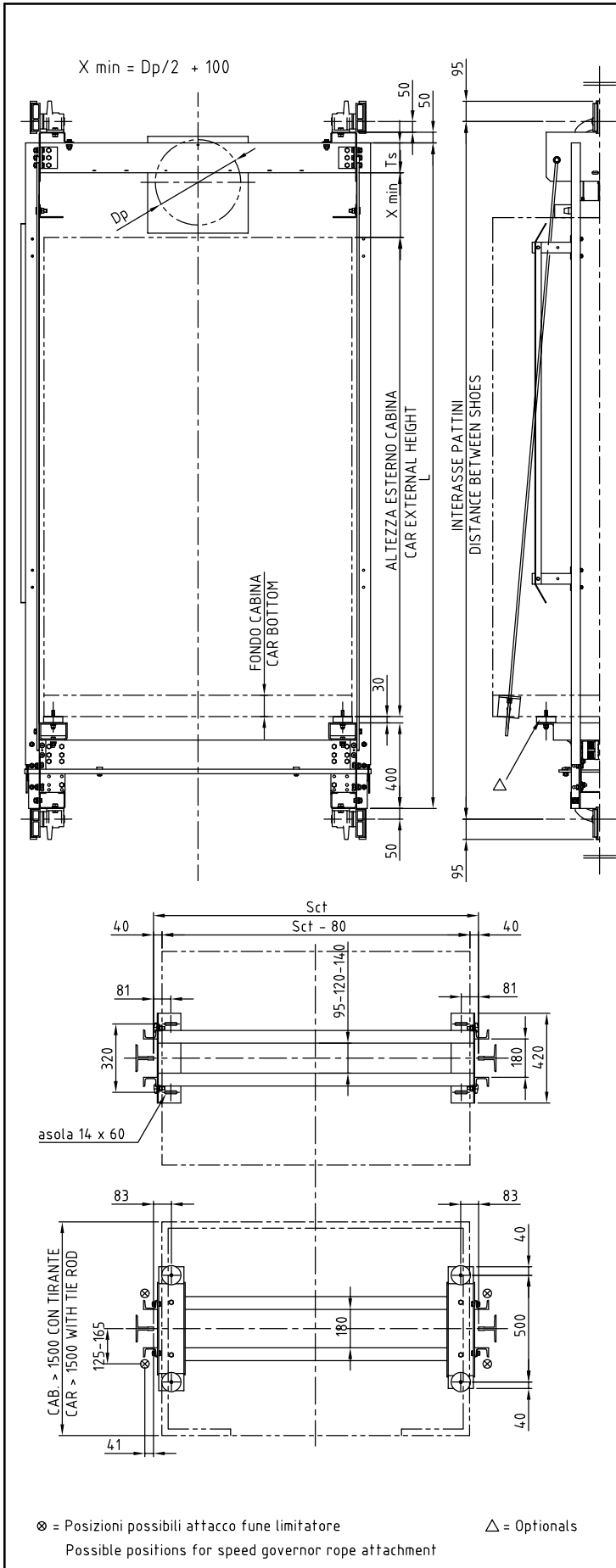

Q = portata rated load
Pc = massa cabina car mass
Pa = massa arcata car frame mass
Px = carico statico max static load max

TIPO/TYPE	36100-140	36100-160
Ts	UPN 140	UPN 160

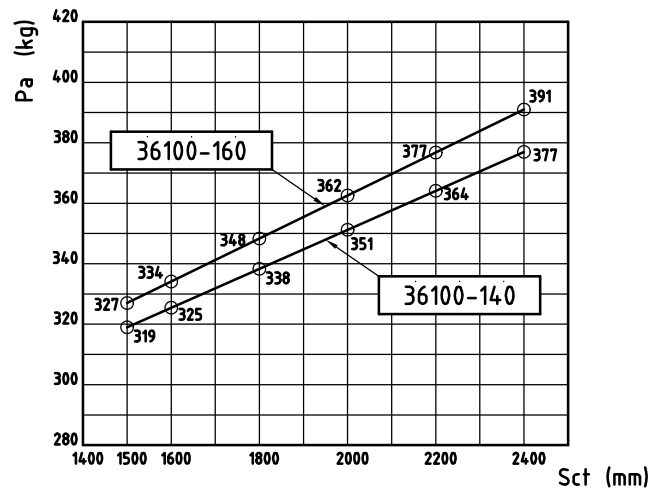
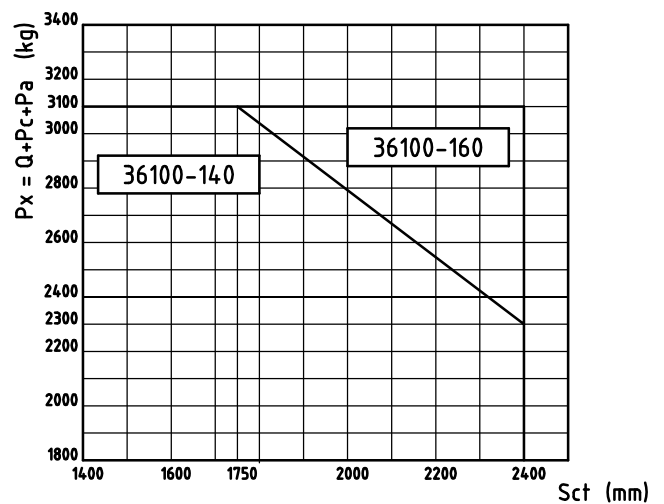

Valori di Pa con montanti standard (L = 3000), escluso massa pulegge.
Pa values with standard side sleepers (L = 3000), mass of pulleys not included.

MAGGIORAZIONE MASSE ADDITIONAL MASSES	kg
Esecuzione con tiranti Execution with tie rods	17.5
Altezza montanti superiore allo standard (ogni 100 mm) Side sleepers higher than standard (each 100 mm)	2,84

IMPIANTI ELETTRICI ARCADE CABINA ELECTRIC ELEVATORS CAR SLINGS

TIPO/TYPE 36.100 (2:1 INF.)

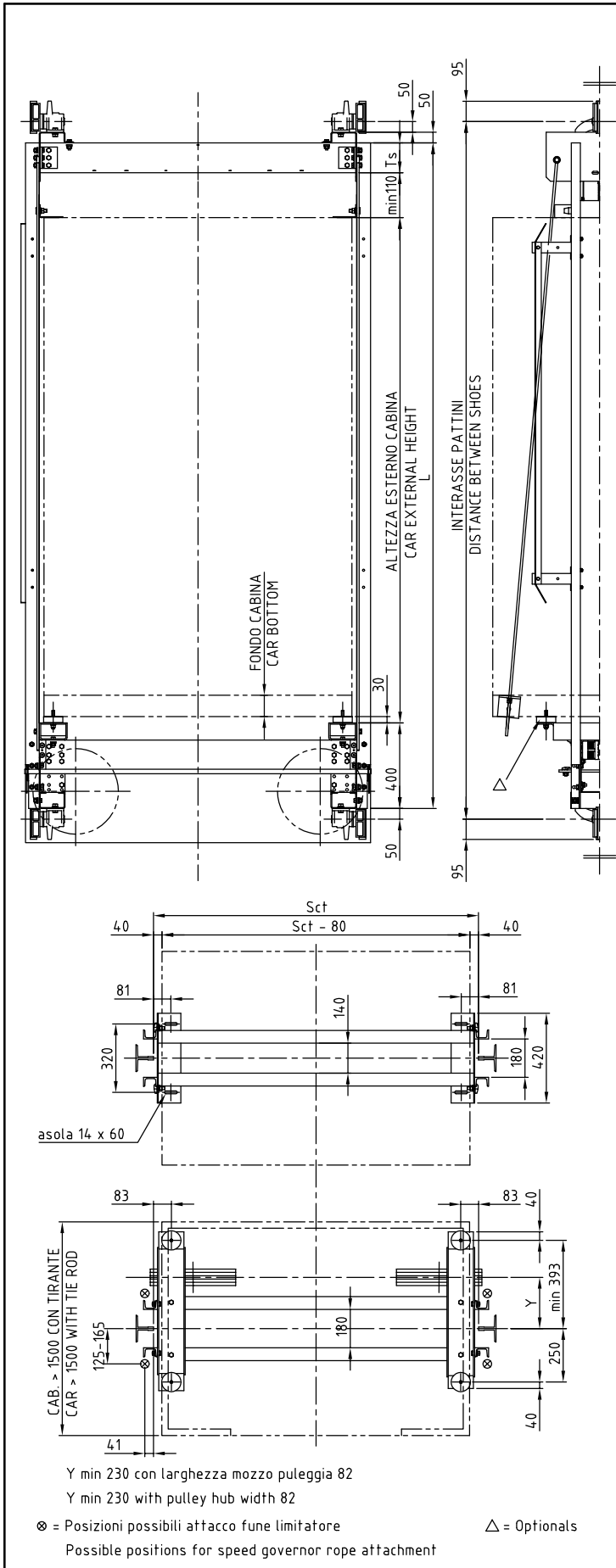

- Q = portata rated load
 P_c = massa cabina car mass
 P_a = massa arcata car frame mass
 P_x = carico statico max static load max

TIPO/TYPE	36100-140	36100-160
T _s	UPN 140	UPN 160

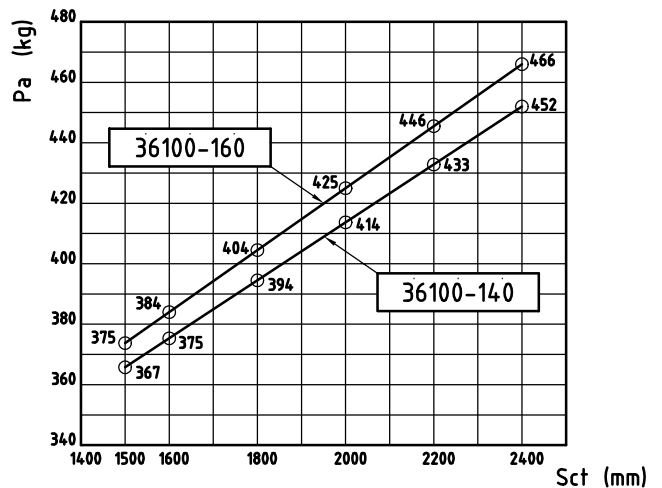
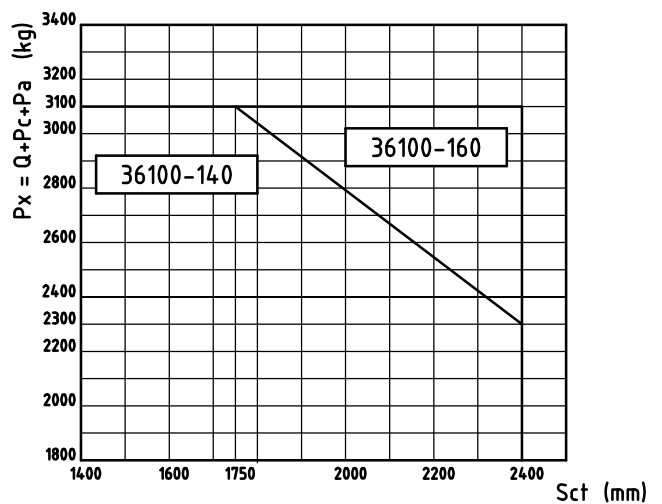

Valori di P_a con montanti standard (L = 3000), escluso massa pulegge.

P_a values with standard side sleepers (L = 3000), mass of pulleys not included.

MAGGIORAZIONE MASSE ADDITIONAL MASSES	kg
Esecuzione con tiranti Execution with tie rods	17.5
Altezza montanti superiore allo standard (ogni 100 mm) Side sleepers higher than standard (each 100 mm)	2,84

Data	Mod. 1	Mod. 2	Mod. 3	Divieto di riproduzione o di divulgazione (Art. 2-99 Legge 22-4-1947 N. 633)	 Centoducati s.p.a.	Tab.
11/07/02	01/08/02					044.00

IMPIANTI ELETTRICI ARCADE CABINA ELECTRIC ELEVATORS CAR SLINGS

TIPO/TYPE 36.200 (1:1)

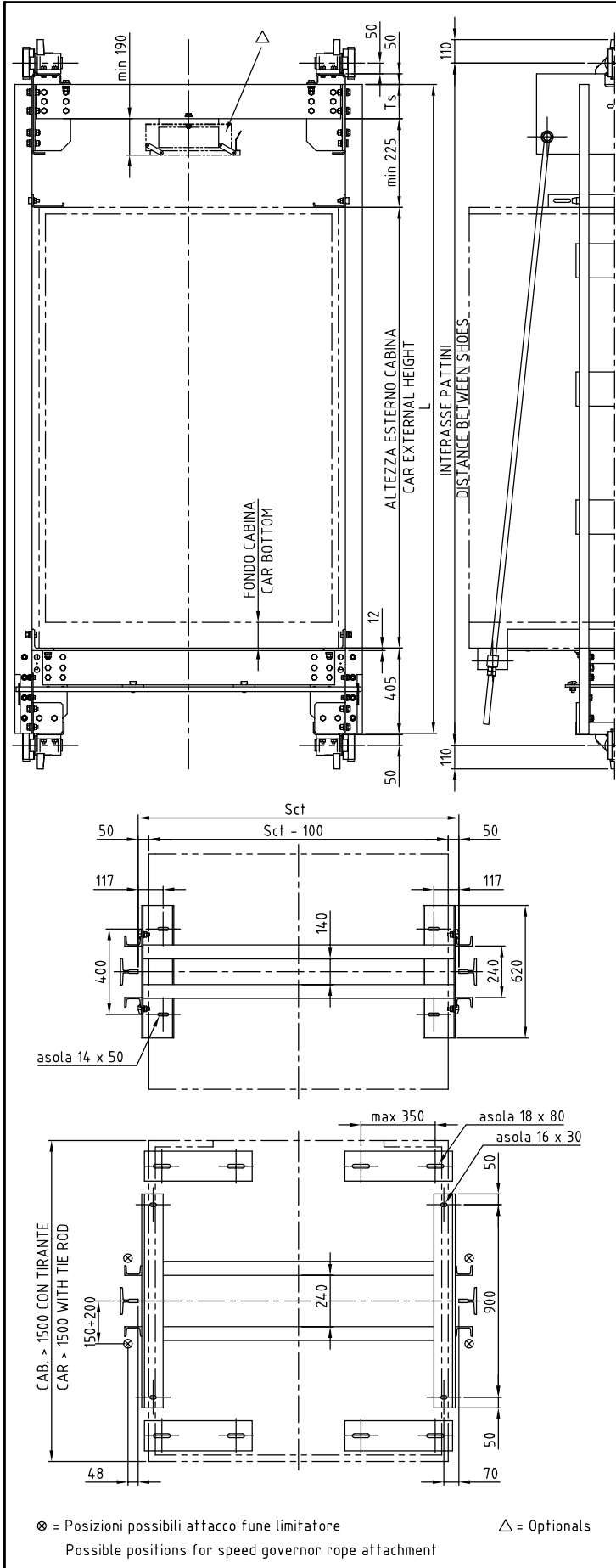

- Q = portata rated load
Pc = massa cabina car mass
Pa = massa arcata car frame mass
Px = carico statico max static load max

TIPO/TYPE	36200-160	36200-180	36200-200
Ts	UPN 160	UPN 180	UPN 200

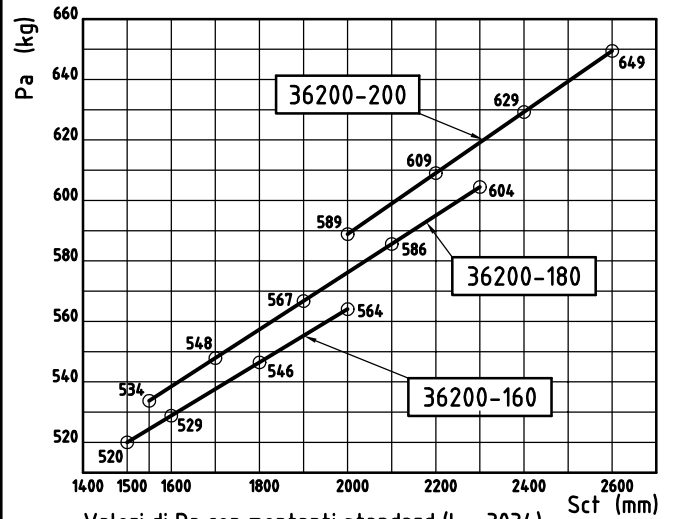
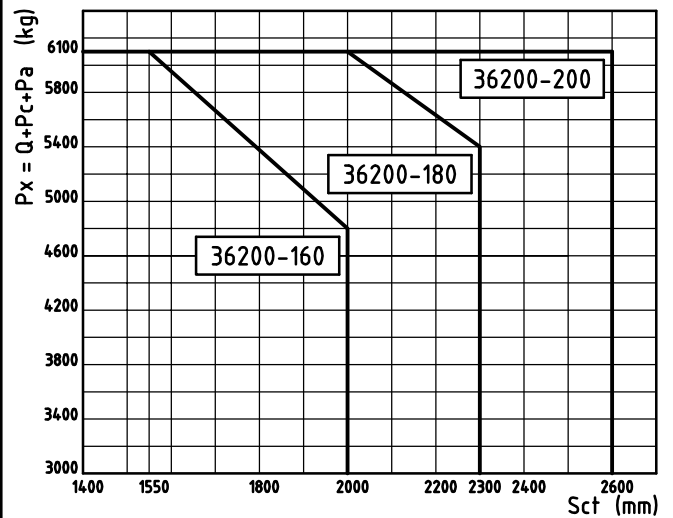

Valori di Pa con montanti standard (L = 3034)

Pa values with standard side sleepers (L = 3034)

MAGGIORAZIONE MASSE ADDITIONAL MASSES	kg
Esecuzione con tiranti M24 L = 4000 Execution with tie rods M24 L = 4000	66
Supporti inferiori cabina Car lower support	37
Altezza montanti superiore allo standard (ogni 100 mm) Side sleepers higher than standard (each 100 mm)	3,46

Data	Mod. 1	Mod. 2	Mod. 3	Divieto di riproduzione o di divulgazione (Art. 2-99 Legge 22-4-1947 N. 633)	 Centoducati s.p.a.	Tab.
01/08/02						045.00

IMPIANTI ELETTRICI ARCADE CABINA ELECTRIC ELEVATORS CAR SLINGS

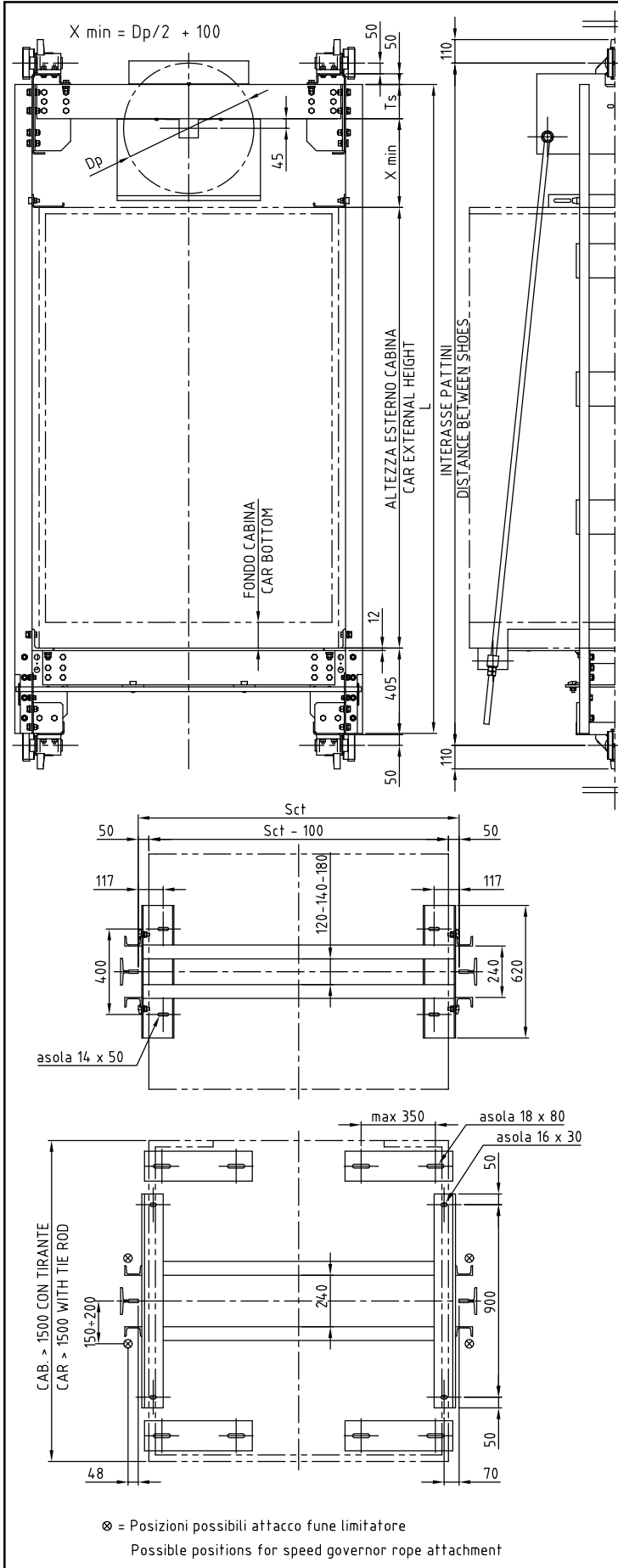

TIPO/TYPE 36.200 (2:1 SUP.) 1P

Q = portata rated load
 P_c = massa cabina car mass
 P_a = massa arcata car frame mass
 P_x = carico statico max static load max

TIPO/TYPE	36200-160	36200-180	36200-200
T _s	UPN 160	UPN 180	UPN 200

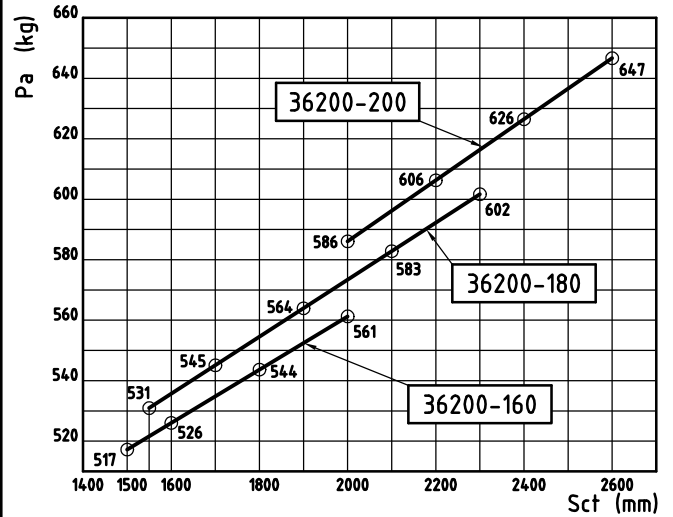
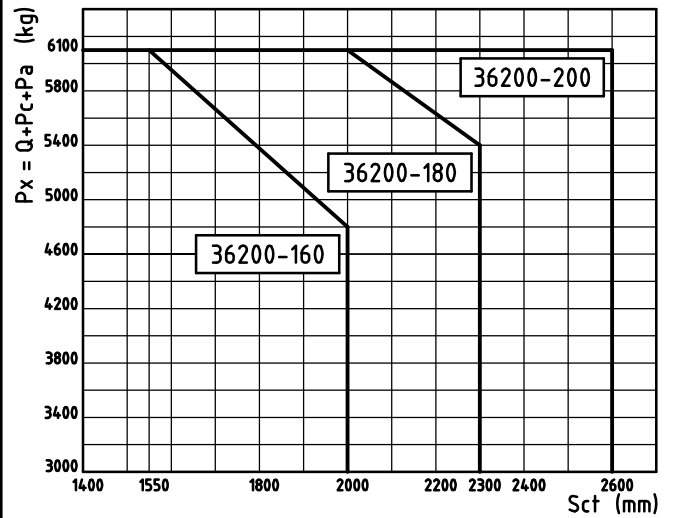

Valori di P_a con montanti standard ($L = 3034$), escluso massa pulegge.

P_a values with standard side sleepers ($L = 3034$), mass of pulleys not included.

MAGGIORAZIONE MASSE ADDITIONAL MASSES	kg
Esecuzione con tiranti M24 L = 4000 Execution with tie rods M24 L = 4000	66
Supporti inferiori cabina Car lower support	37
Altezza montanti superiore allo standard (ogni 100 mm) Side sleepers higher than standard (each 100 mm)	3,46

IMPIANTI ELETTRICI ARCADE CABINA ELECTRIC ELEVATORS CAR SLINGS

TIPO/TYPE 36.200 (2:1 SUP.) 2P

Q = portata rated load
 Pc = massa cabina car mass
 Pa = massa arcata car frame mass
 Px = carico statico max static load max

TIPO/TYPE	36200-160	36200-180	36200-200
Ts	UPN 160	UPN 180	UPN 200

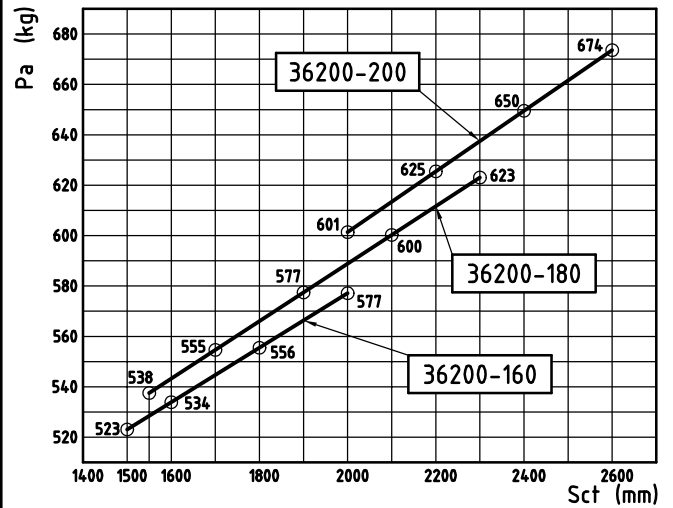
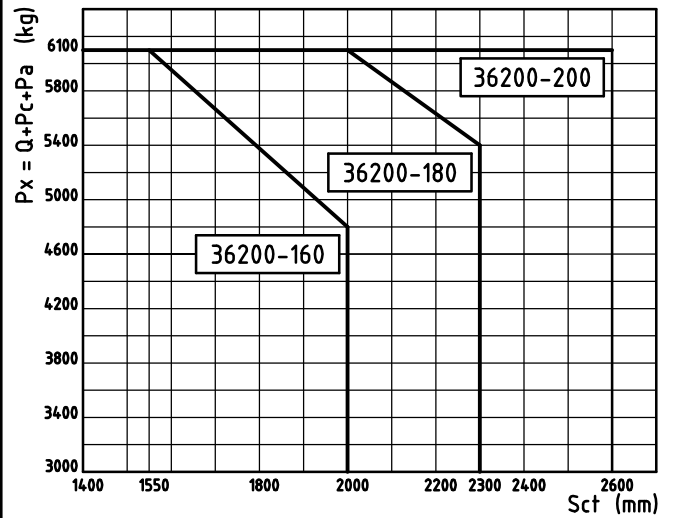

Valori di P_a con montanti standard ($L = 3034$), escluso massa pulegge.

P_a values with standard side sleepers ($L = 3034$), mass of pulleys not included.

MAGGIORAZIONE MASSE ADDITIONAL MASSES	kg
Esecuzione con tiranti M24 $L = 4000$ Execution with tie rods M24 $L = 4000$	66
Supporti inferiori cabina Car lower support	37
Altezza montanti superiore allo standard (ogni 100 mm) Side sleepers higher than standard (each 100 mm)	3,46

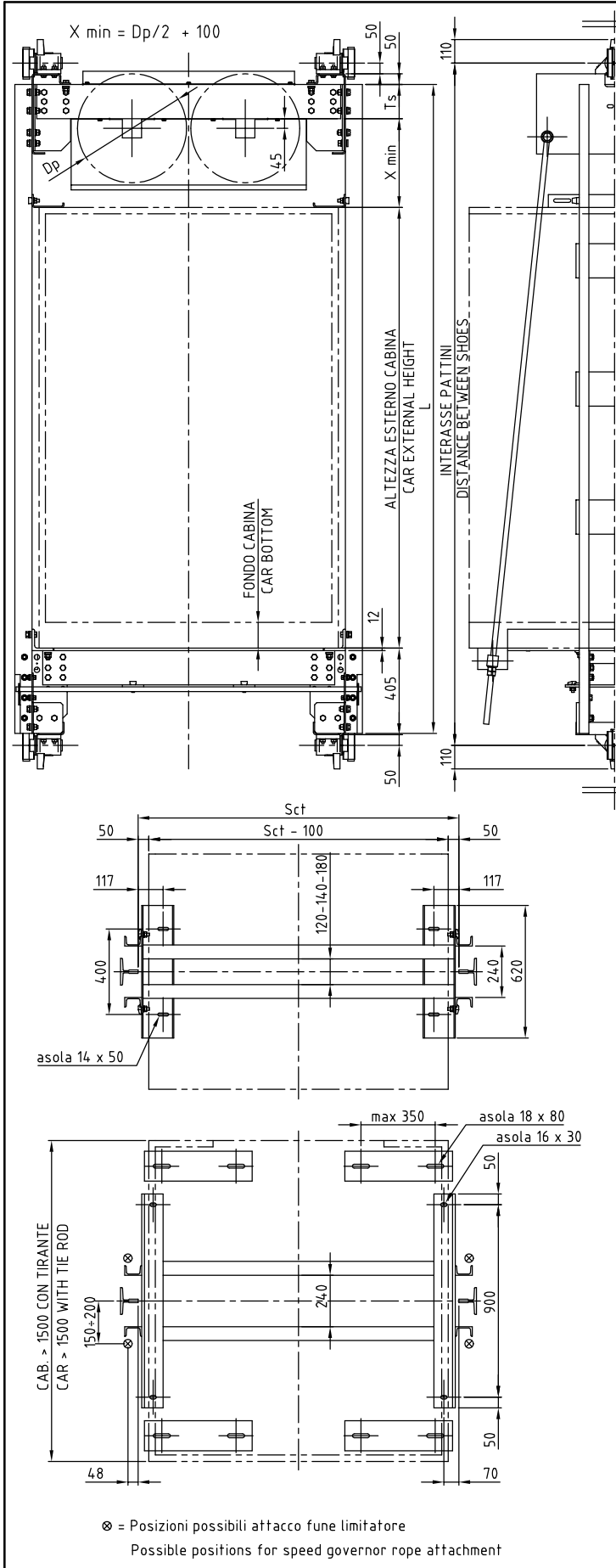

Data	Mod. 1	Mod. 2	Mod. 3
01/08/02			

Divieto di riproduzione o di divulgazione
 (Art. 2-99 Legge 22-4-1947 N. 633)

Centoducati s.p.a.

Tab.
047.00

IMPIANTI ELETTRICI ARCADE CABINA ELECTRIC ELEVATORS CAR SLINGS

TIPO/TYPE 36.200 (2:1 INF.)

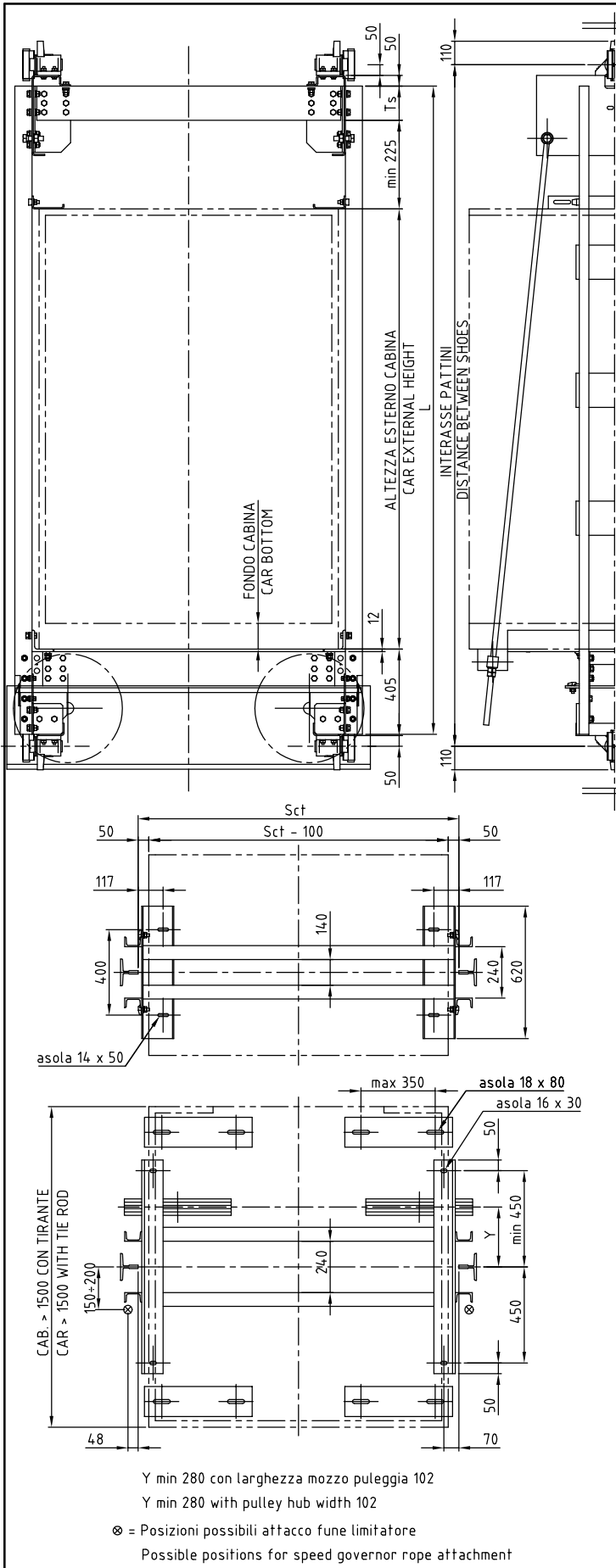

Q = portata rated load
Pc = massa cabina car mass
Pa = massa arcata car frame mass
Px = carico statico max static load max

TIPO/TYPE	36200-160	36200-180	36200-200
Ts	UPN 160	UPN 180	UPN 200

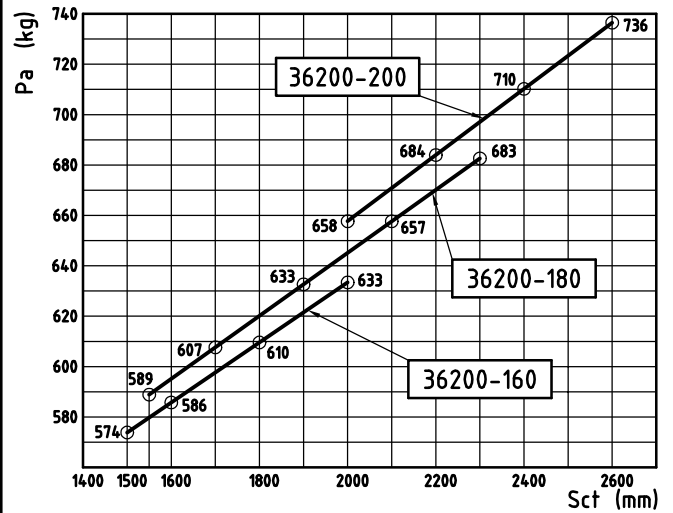
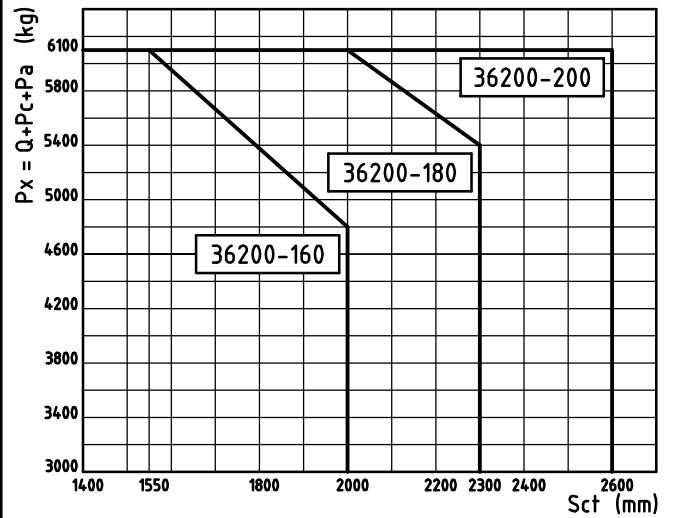

Valori di Pa con montanti standard (L = 3034), escluso massa pulegge.

Pa values with standard side sleepers (L = 3034), mass of pulleys not included.

MAGGIORAZIONE MASSE ADDITIONAL MASSES	kg
Esecuzione con tiranti M24 L = 4000 Execution with tie rods M24 L = 4000	66
Supporti inferiori cabina Car lower support	37
Altezza montanti superiore allo standard (ogni 100 mm) Side sleepers higher than standard (each 100 mm)	3,46

IMPIANTI ELETTRICI ARCADE CABINA
ELECTRIC ELEVATORS CAR SLINGS

EN 81-1:1985

Data	Mod. 1	Mod. 2	Mod. 3	Divieto di riproduzione o di divulgazione (Art. 2-99 Legge 22-4-1947 N. 633)	 Centoducati s.p.a.	Tab.
01/08/02						049.00

IMPIANTI ELETTRICI - ARCADE CABINE EN81-1: (1985) ELECTRIC ELEVATORS - CAR FRAMES EN81-1: (1985)

TIPO / TYPE 35.350 (1:1)

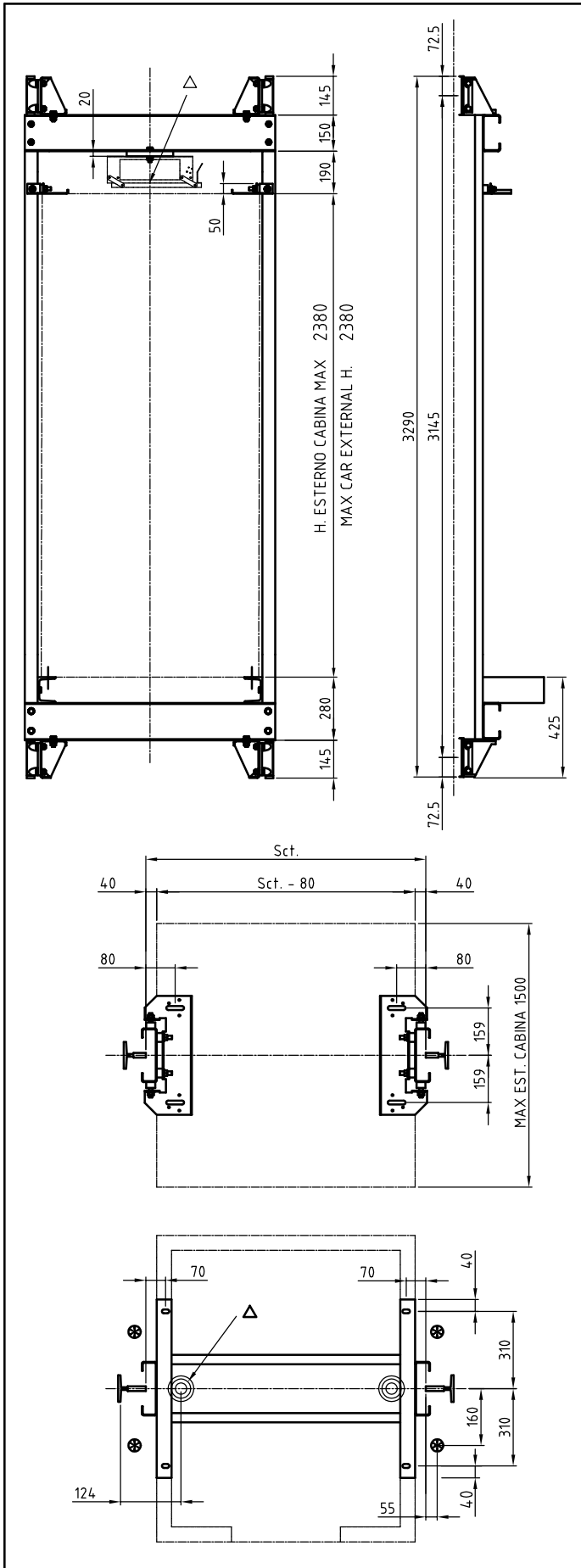

Diagrammi di utilizzo

Utilisation diagram

Q = portata

rated load

Pc = massa cabina

car mass

Pa = massa arcata

car frame mass

Px = carico statico max

static load max

$P_x = Q + P_c + P_a$ (kg)

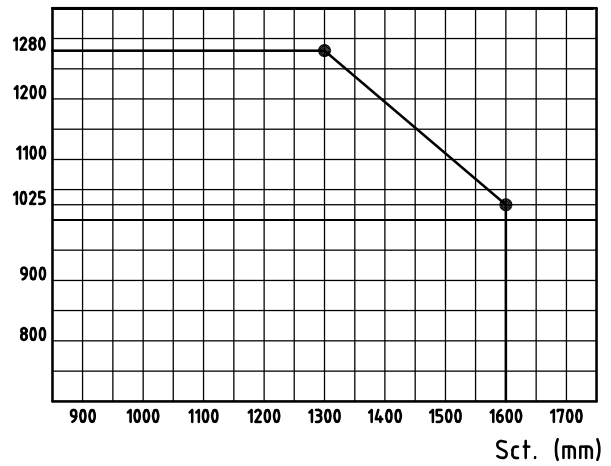

Pa (kg)

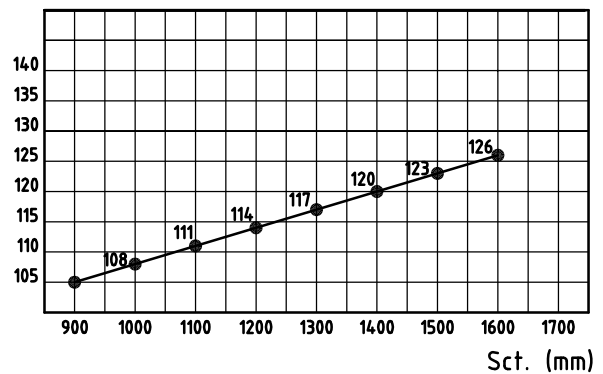

△ Optionals

⊗ Posizioni possibili attacco funi limitatore

⊗ Possible positions for speed governor rope attachment

Data	Mod. 1	Mod. 2	Mod. 3	Divieto di riproduzione o di divulgazione (Art. 2-99 Legge 22-4-1947 N. 633)	 Centoducati s.p.a.	Tab.
03/02/03	25/03/03					050.00

IMPIANTI ELETTRICI ARcate CABINA EN81-1:(1985) ELECTRIC ELEVATORS CAR SLINGS EN81-1:(1985)

TIPO/TYpe 35.450 (1:1)

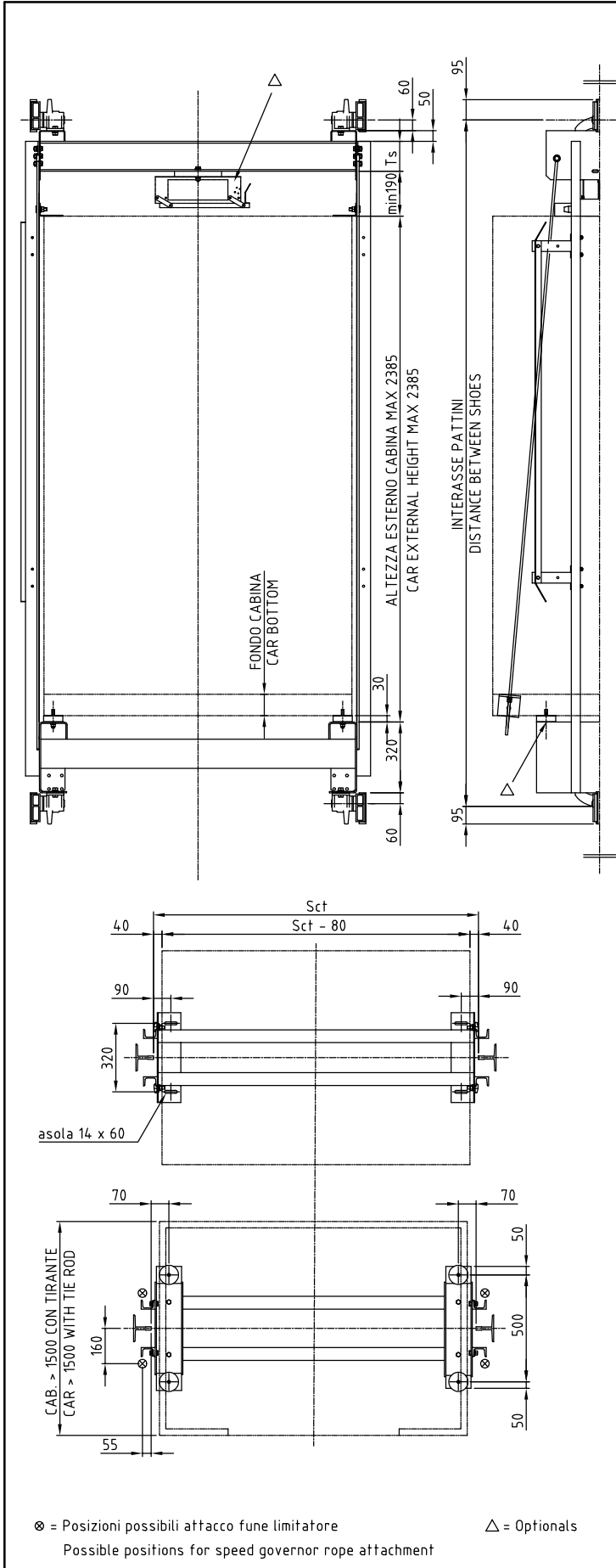

Q = portata rated load
Pc = massa cabina car mass
Pa = massa arcata car frame mass
Px = carico statico max static load max

TIPO/TYpe	(140/65)	(160/65)	(180/65)
Ts	UPN 140	UPN 160	UPN 180
Ti	UPN 100	UPN 120	UPN 140
M	UPN 65	UPN 65	UPN 65

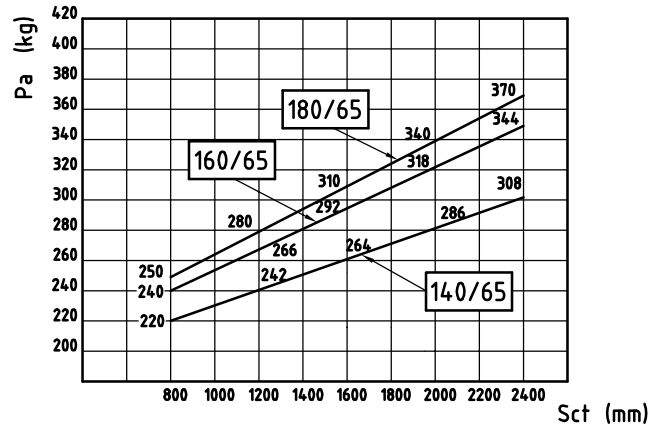
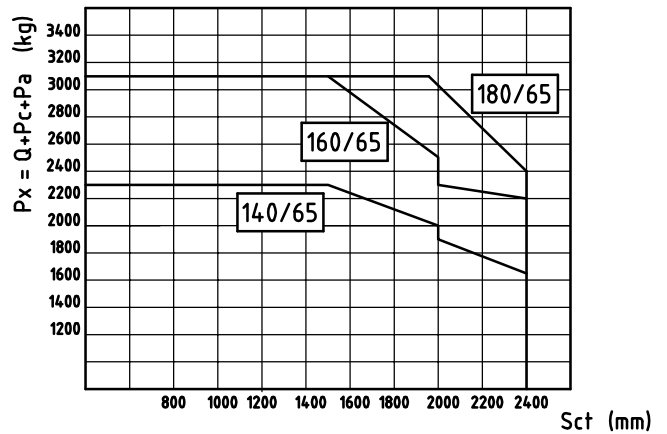

Valori di P_a con altezza cabina 2385 mm.

P_a values with car height 2385 mm.

MAGGIORAZIONE MASSE ADDITIONAL MASSES	140/65	160/65	180/65
	kg	kg	kg
Esecuzione con tiranti Execution with tie rods	17.5	17.5	17.5
Altezza montanti superiore allo standard (ogni 100 mm) Side sleepers higher than standard (each 100 mm)	2,84	2,84	2,84

IMPIANTI ELETTRICI ARCADE CABINA EN81-1:(1985) ELECTRIC ELEVATORS CAR SLINGS EN81-1:(1985)

TIPO/TYPE 35.450 (2:1)

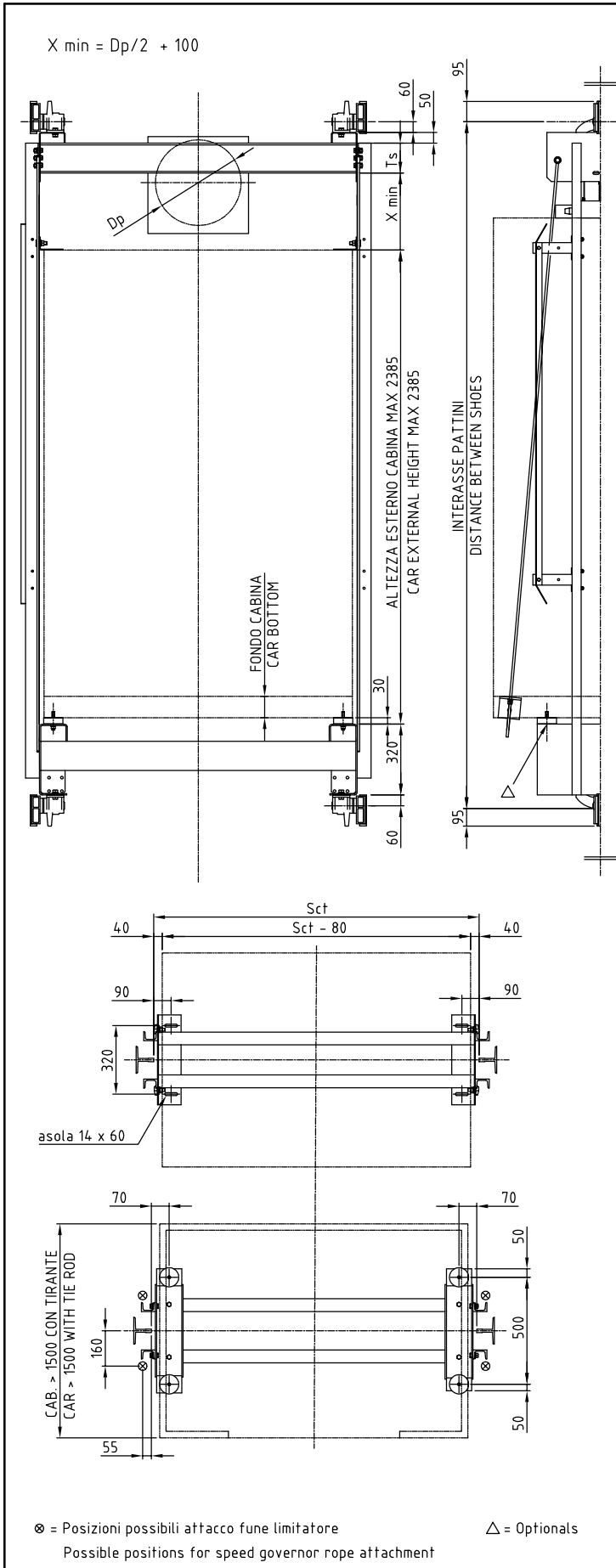

- Q = portata rated load
 Pc = massa cabina car mass
 Pa = massa arcata car frame mass
 Px = carico statico max static load max

TIPO/TYPE	(140/65)	(160/65)	(180/65)
Ts	UPN 140	UPN 160	UPN 180
Ti	UPN 100	UPN 120	UPN 140
M	UPN 65	UPN 65	UPN 65

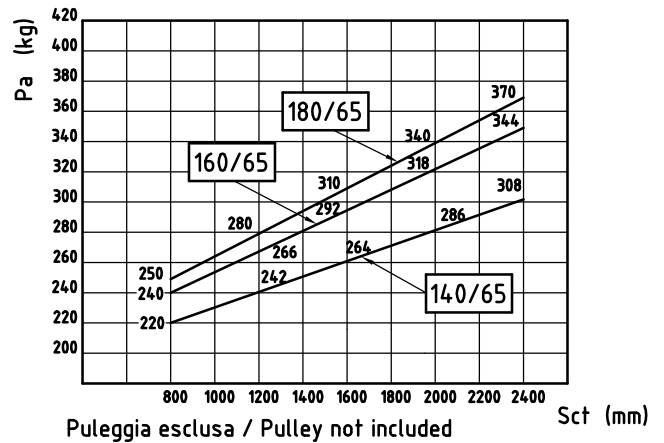
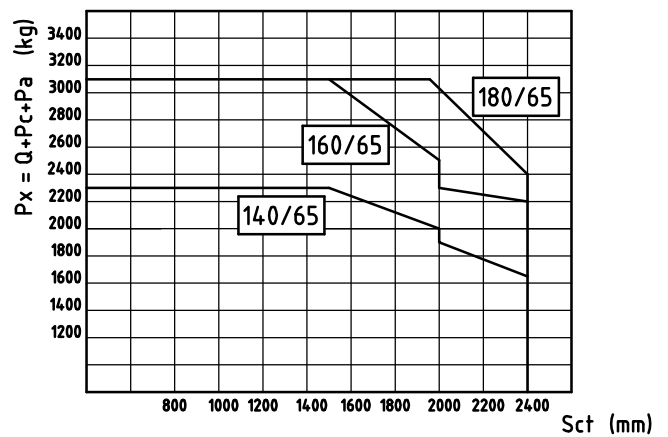

Valori di Pa con altezza cabina 2385 mm.
 Pa values with car height 2385 mm.

MAGGIORAZIONE MASSE ADDITIONAL MASSES	140/65 kg	160/65 kg	180/65 kg
Esecuzione con tiranti Execution with tie rods	17,5	17,5	17,5
Altezza montanti superiore allo standard (ogni 100 mm) Side sleepers higher than standard (each 100 mm)	2,84	2,84	2,84

IMPIANTI ELETTRICI ARCADE CABINA EN81-1:(1985) ELECTRIC ELEVATORS CAR SLINGS EN81-1:(1985)

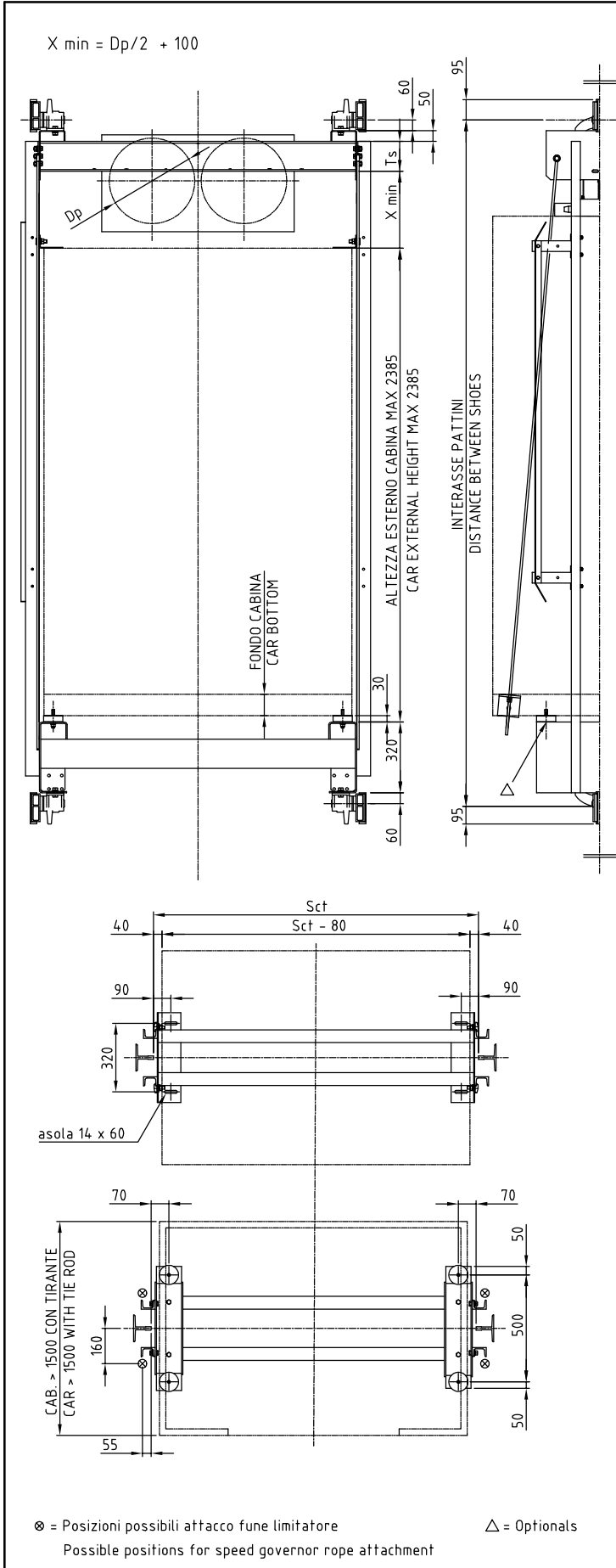

TIPO/TYPE 35.450 (2:1)

Q = portata rated load
Pc = massa cabina car mass
Pa = massa arcata car frame mass
Px = carico statico max static load max

TIPO/TYPE	(140/65)	(160/65)	(180/65)
Ts	UPN 140	UPN 160	UPN 180
Ti	UPN 100	UPN 120	UPN 140
M	UPN 65	UPN 65	UPN 65

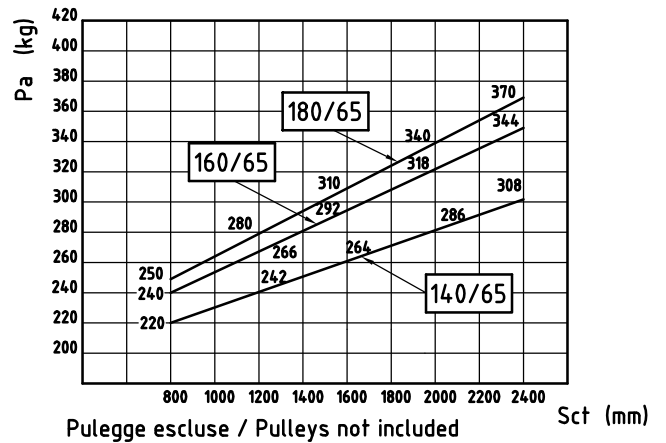
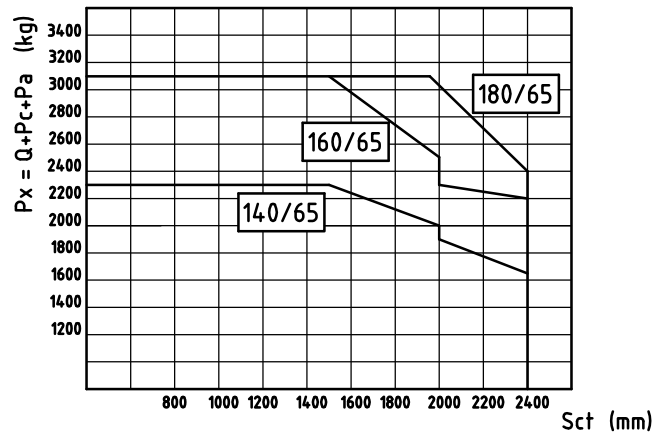

Valori di Pa con altezza cabina 2385 mm.
Pa values with car height 2385 mm.

Data	Mod. 1	Mod. 2	Mod. 3	Divieto di riproduzione o di divulgazione (Art. 2-99 Legge 22-4-1947 N. 633)	 Centoducati s.p.a.	Tab.
04/02/03	20/02/03					053.00

IMPIANTI ELETTRICI ARcate CABINA EN81-1:(1985) ELECTRIC ELEVATORS CAR SLINGS EN81-1:(1985)

TIPO/TYpe 35.450 (2:1)

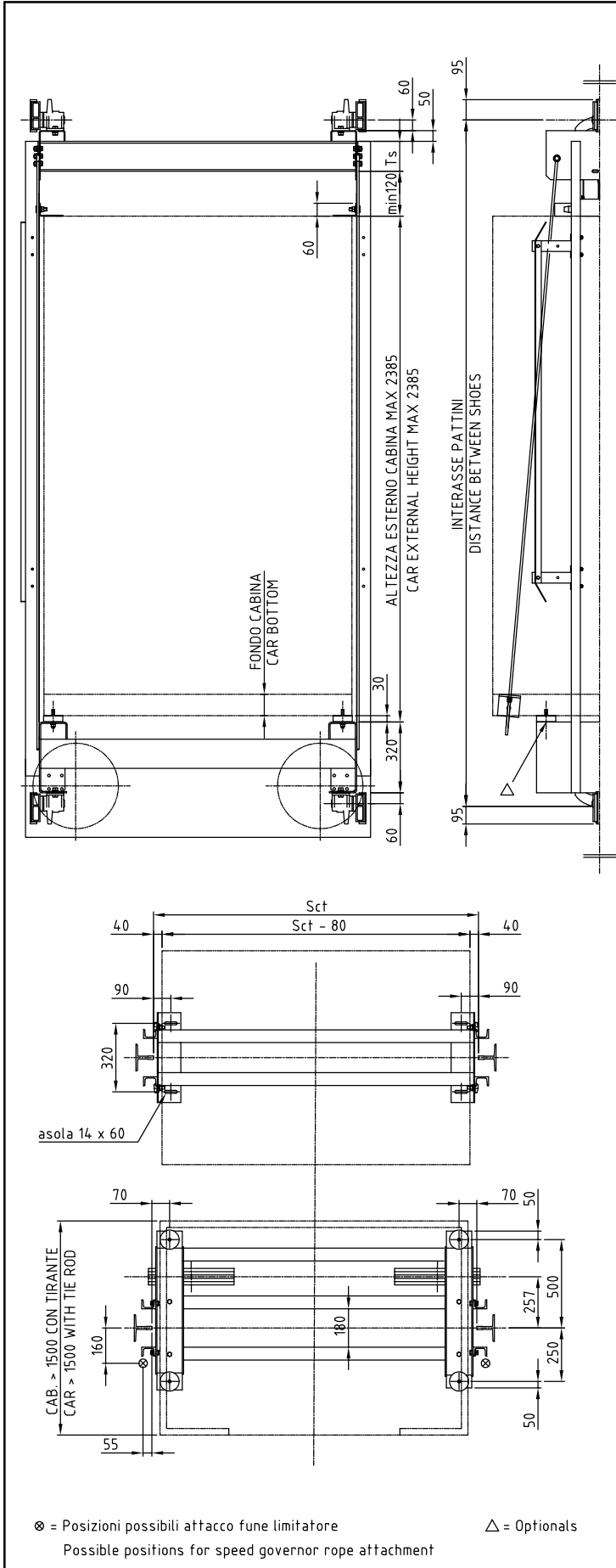

Q = portata rated load
Pc = massa cabina car mass
Pa = massa arcata car frame mass
Px = carico statico max static load max

TIPO/TYpe	(140/65)	(160/65)	(180/65)
Ts	UPN 140	UPN 160	UPN 180
Ti	UPN 100	UPN 120	UPN 140
M	UPN 65	UPN 65	UPN 65

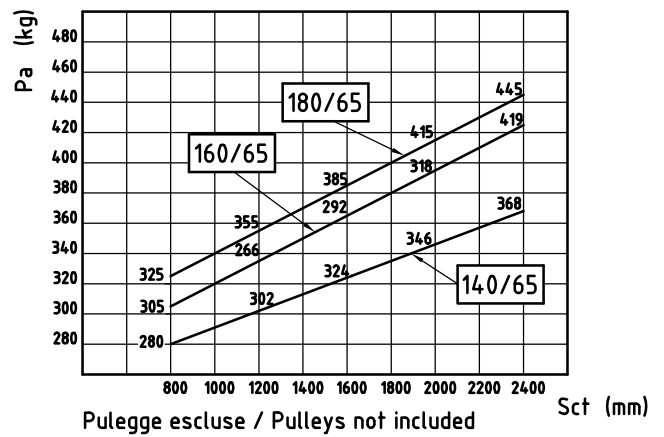
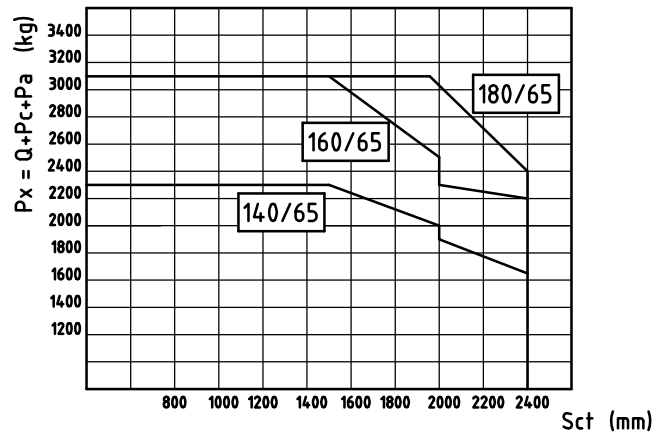

Valori di Pa con altezza cabina 2385 mm.
Pa values with car height 2385 mm.

MAGGIORAZIONE MASSE ADDITIONAL MASSES	140/65	160/65	180/65
	kg	kg	kg
Esecuzione con tiranti Execution with tie rods	17,5	17,5	17,5
Altezza montanti superiore allo standard (ogni 100 mm) Side sleepers higher than standard (each 100 mm)	2,84	2,84	2,84